

Montpellier

THE PERFECT BALANCE OF FUNCTION AND STYLE

LAUNDRY - DISHWASHING - COOKING - COOLING

Installation and Operating Instructions



194.5cm Tall Combi Fridge Freezer **MS310-2 - White & Silver MS317-2W - White**

Please read these instructions carefully before attempting to install or use this appliance.
We recommend that you keep these instructions in a safe place for future reference.

Welcome

Thank you for choosing this Montpellier fridge freezer.

Our refrigeration products have been designed to provide you with the best combination of style, reliability and performance to give you years of trouble-free use.

You may be familiar with a similar product, but please take time to read these instructions carefully before installing or using your fridge freezer to ensure you get the most from your purchase.

We recommend that you keep this manual in a safe place for future reference.

Your fridge freezer is covered by a comprehensive two year Parts & Labour Guarantee. In the unlikely event that you experience a problem with your fridge freezer, you can rest assured that you are fully protected against the cost of repairs for the first two years. Please note that any claim must be accompanied by the model reference number, serial number and proof of purchase.

To activate your guarantee, you will need your product serial number. This can be found on the rear of the machine.

There are two ways to register your Guarantee:

- **Online:** Visit the Support page on our website and complete the online Product Registration form. www.montpellier-appliances.com
- **By Post:** Simply detach and fill in the form provided, attach a stamp and send it in the post. Don't forget to include your e-mail address so that we can send confirmation through to you.



Note: We are unable to take registrations over the phone.



2
YEAR
GUARANTEE
— PARTS & LABOUR —
ACROSS INTEGRATED COOLING
Montpellier
www.montpellier-appliances.com

GUIDELINES CONCERNING THE SAFETY OF USE	1
GENERAL INFORMATION	3
DESCRIPTION OF THE APPLIANCE, BASIC PARTS	4
INSTALLATION AND OPERATING CONDITIONS OF THE APPLIANCE	6
ELECTRONIC CONTROL PANEL DESCRIPTION. TEMPERATURE REGULATION	8
USING THE REFRIGERATOR-FREEZER EFFICIENTLY	10
DEFROSTING	12
CLEANING AND CARE	13
CHANGING THE DIRECTION OF THE DOOR OPENING	13
TROUBLE-SHOOTING	15
TRANSPORT	16
ENVIRONMENTAL PROTECTION	16
PRODUCT FICHE	17

GUIDELINES CONCERNING THE SAFETY OF USE

Some provisions in this user manual are unified for refrigerating products of different types (for a refrigerator, refrigerator-freezer or freezer). CAREFULLY READ THE INSTRUCTION MANUAL. The Manufacturer shall not be held liable for damage arising from the failure to observe the instructions contained in this manual. Keep this manual for future reference, or to pass it over to the next user.

- Do not cover the ventilation holes at the top and on the sides of the appliance.
- Do not use any mechanical means or electrical devices to hasten the thawing process when cleaning the freezer compartment.
- Do not use electrical appliances inside the food storage compartments of the appliance, unless they are of the type recommended by the manufacturer.
- If the supply cord is damaged it must be replaced by the manufacturer, manufacturer service agent or a similarly qualified person, in order to avoid a hazard.
- Disposal of the appliance should be according to national rules.
- Do not damage the appliance refrigeration system. It contains the refrigerant gas R600a. If the refrigeration system is damaged:



- Do not use any open flame.
- Avoid sparks—do not turn on any electrical appliances or lighting fixtures.
- Immediately ventilate the room.
- Air the room in which the appliance is placed for a few minutes (the size of the room for a product containing isobutane / R600a must be at least 4 m³) to avoid damage to the cooling system.
- Do not allow children to play with the appliance or to plug it in or unplug from the electricity supply socket. Do not allow children to play with the packaging material from the appliance.
- This appliance can be used by children aged from 8 years and above and persons with reduced physical, sensory or mental capabilities or lack of experience and knowledge if they have been given supervision or instruction concerning use of the appliance in a safe way and understand the hazards involved.
- Cleaning and user maintenance shall not be made by children without supervision.



The appliance should only be connected to an earthed socket installed in accordance with the regulations. Make sure that the supply voltage corresponds with the voltage marked on the rating label. This product complies with all binding CE labelling directives. The earthed electrical socket by which the appliance is connected to the mains should be in an accessible place. It is a legal requirement that the appliance is properly earthed. The manufacturer will not be held liable for any damage or injury which may result from the failure to fulfil this requirement.

- TO AVOID THE EXPOSURE TO DANGER, ALWAYS HAVE FAULTY CABLE BE REPLACED ONLY BY THE MANUFACTURER, BY OUR CUSTOMER SERVICE OR BY QUALIFIED PERSON AND WITH A CABLE OF THE SAME TYPE.
- It is forbidden to readjust or modify any parts of the unit. It is crucial not to damage the capillary tube visible in the compressor recess. The tube may not be bent, straightened or wound. If the capillary tube is damaged by the user the guarantee will be void.
- It is forbidden to use a technically damaged appliance.
- The appliance can't be disposed of by burning.
- Do not store beverages in bottles and cans, especially carbonated beverages, in the freezer chamber. The cans and the bottles may explode.
- Do not put frozen products, taken out directly from the freezer (lollies, ice cubes, etc.) into your mouth; their low temperature may cause severe frost-bite.
- The appliance should be used only for freezing and storing foodstuffs.
- This appliance is not designed for the storage of explosive substances such as aerosol cans with a flammable propellant.
- It is prohibited to store petrol and other flammable liquids near the appliance.
- The appliance operates properly at the ambient temperature (see product fiche). Do not use it in the cellar, unheated summer cottage during autumn and winter.
- Pull the plug out from the mains socket before each maintenance activity. Do not pull on the cord, but hold the body of the plug instead.
- When performing activities, such as cleaning, maintenance or moving, the appliance must be completely disconnected from power supply (by pulling the plug out from the socket)
- If the appliance is unplugged (for cleaning, moving to another place, etc.), it may be repeatedly switched ON AFTER **15 MIN**.

- Do not place any switched on electrical devices (such as microwave ovens, hair dryers, irons, electric kettles or other electrical devices) on top of the appliance because this may cause ignition of plastic parts.
- Do not place any dishes with liquids on top of the appliance and do not keep flowers in vases or other liquid-filled vessels on the appliance.
- Do not climb on or sit on the appliance, do not lean on or hang on the appliance doors and do not allow children to do this.



DO NOT TRY REPAIR THE APPLIANCE ON YOUR OWN. ALWAYS CONTACT AN AUTHORIZED TECHNICIAN. TO AVOID THE EXPOSURE TO DANGER, ALWAYS HAVE FAULTY CABLE BE REPLACED ONLY BY THE MANUFACTURER, BY OUR CUSTOMER SERVICE OR BY QUALIFIED PERSON WITH A CABLE OF SAME TYPE.

ATTENTION! DO NOT REMOVE THE COVER OF THE LIGHT EMITTING DIODE (LED) LUMINAIRE! If the cooling appliance is equipped with light emitting diode (LED) luminaire and the lighting is not functioning, please contact a maintenance technician to have it replaced. THE LUMINAIRE CAN BE REPLACED ONLY BY A MAINTENANCE TECHNICIAN!

GENERAL INFORMATION

Model MS317-2W

The appliance is a two-compartment refrigerator-freezer combination. The freezer compartment is equipped with a frost-free refrigeration system ("No Frost"). The refrigerator compartment is designed for the brief storage of fresh food. The freezer compartment is designed for the freezing and long-term storage of food products.

In the refrigerator compartment is the cold section. A temperature of -2 °C to +3 °C is maintained in the cold section which is suitable for short-term storage of meat, fish and similar products.

Model MS310-2W

The appliance is a two-compartment refrigerator-freezer combination. The refrigerator compartment is designed for the brief storage of fresh food. The freezer compartment is designed for the freezing and long-term storage of food products.

THE MANUFACTURER GUARANTEES RELIABLE OPERATION OF THE REFRIGERATOR WHEN THE RELATIVE AIR HUMIDITY NOT GREATER THAN 70 PER CENT AND THE AMBIENT TEMPERATURE IS:

- +16 TO +32 DEGREES CELSIUS (Climate class **N**);
- +16 TO +38 DEGREES CELSIUS (Climate class **ST**).
- +16 TO +43 DEGREES CELSIUS (Climate class **T**).

DESCRIPTION OF THE APPLIANCE, BASIC PARTS

Model MS317-2W



A – Refrigerator compartment
B – Freezer compartment

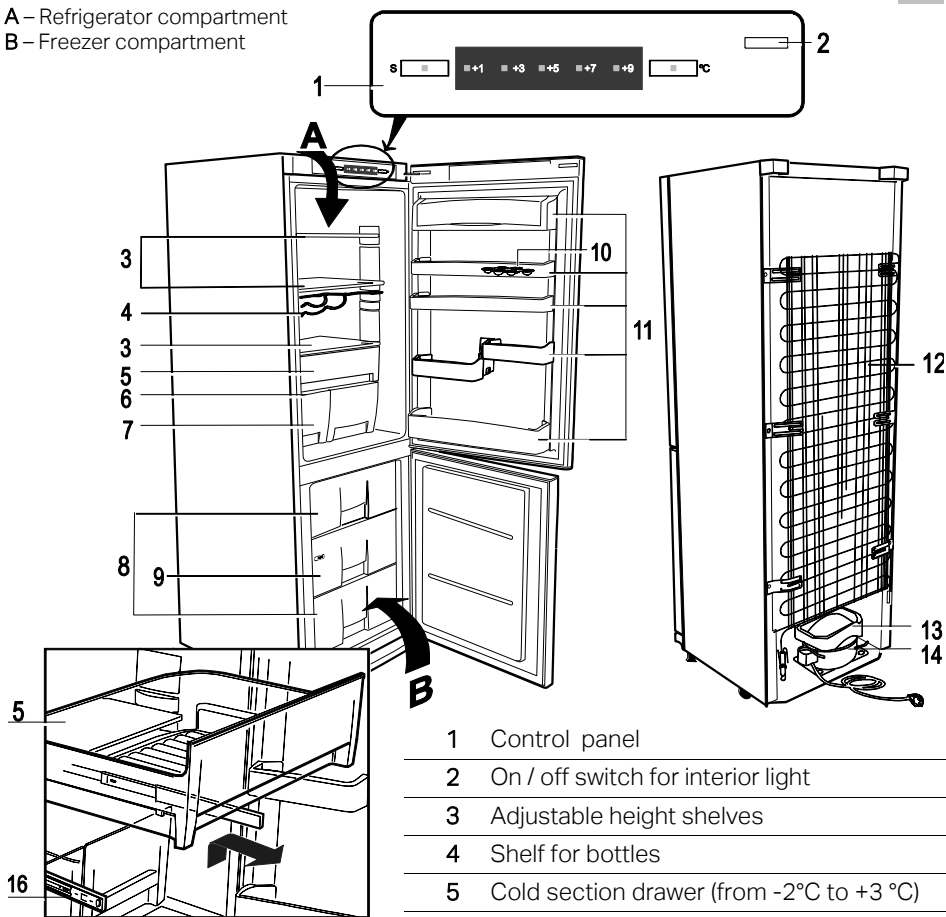

The transparent cold section drawer **5** moves on roller bearings **16**. The drawer can be removed by pulling it out, and lifting it off the rails.

- | | |
|----|--|
| 1 | Control panel |
| 2 | On / off switch for interior light |
| 3 | Adjustable height shelves |
| 4 | Shelf for bottles |
| 5 | Cold section drawer (from -2°C to +3 °C) |
| 6 | Glass shelf |
| 7 | Fruit and vegetable boxes (2 pcs.) |
| 8 | Frozen products section(s) |
| 9 | Fast-freeze section |
| 10 | Egg tray |
| 11 | Adjustable height door trays |
| 12 | Condenser |
| 13 | Thaw water drip tray |
| 14 | Compressor |

Model MS310-2W

2

A – Refrigerator compartment
B – Freezer compartment

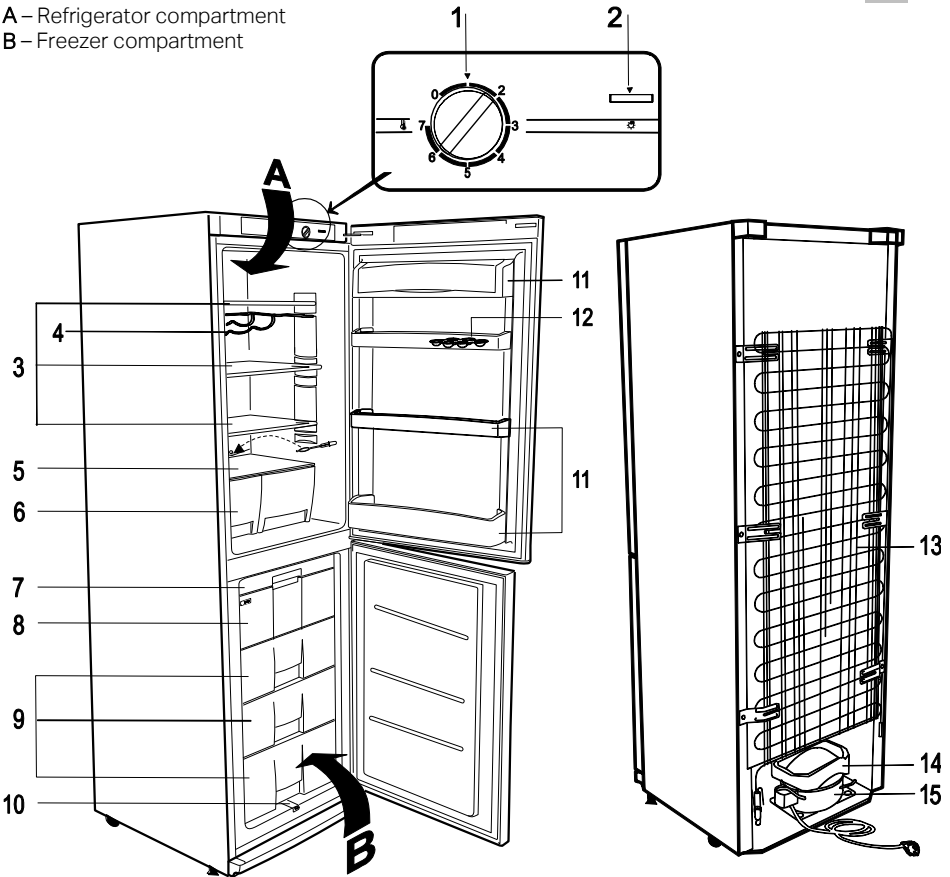

1 Thermostat knob

2 On / off switch for interior light

3 Adjustable height shelves

4 Shelf for bottles

5 Glass shelf

6 Fruit and vegetable boxes (2 pds.)

7 Section for small food products

8 Fast-freeze section

9 Frozen products section(s)

10 Thaw water channel chamfer

11 Adjustable height door trays

12 Egg tray

13 Condenser

14 Thaw water drip tray

15 Compressor

INSTALLATION AND OPERATING CONDITIONS OF THE APPLIANCE

Installation before using the appliance for the first time

It is recommended to prepare the appliance for operation with a helper.

- Remove package. Lift the appliance away from foamed polystyrene base. Tear off adhesive tapes.
- When positioning the appliance in chosen location, it will move more easily into position if you lift the front a little and incline it backward, allowing it to roll on its casters. Moving or positioning the appliance do not tilt it by more than 40° from the vertical position.



When placing, moving, lifting the appliance, do not hold the door handles, do not pull the condenser at the rear part of the refrigerator and do not touch the compressor unit.

- Remove all red-coloured parts from the shelves. Tear away the adhesive tapes from the door trays – they are intended only for the transport of the appliance.

NOTE. When you open the freezer compartment door a little red packing detail will fall out – IT IS FOR TRANSPORTATION PURPOSES ONLY.

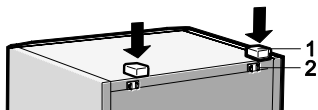

- ◀ Take two supports **1** from the bag and insert them into the guides **2** at the top back part of the appliance (see picture).
- If the appliance is brought in from the cold (temperature is not higher than +12 °C), **you**

should wait for two hours before connecting it to the mains.



The appliance **should not be connected** to the mains until all packing and transport materials aren't removed. Suitably dispose the packaging material.

Connection to the mains

- This appliance should be connected to AC 220-240V 50Hz supply socket. The socket must be fitted properly, and must be supplied with an earthing conduit and a 10A fuse. It is a legal requirement that the appliance is properly earthed. The manufacturer will not be held liable for any damage or injury which may result from the failure to fulfil this requirement.
- Do not use adapters, multiple sockets and two-wire extension leads. If it is necessary to use the extension lead, it must be equipped with a protection ring and a single socket and must have a VDE/GS safety certificate.
- If an extension lead is used (with a protection ring and safety certificate), its socket must be located at a safe distance, away from the sinks, and must not be in a place where it could be flooded by water or waste water.
- When positioning the appliance, be careful that the electrical cord isn't squeezed in order to avoid its damage. Do not store heavy objects such as cooling devices, furniture or other domestic devices next the appliance in such a way that they could squeeze and damage the electrical cord. This can cause a short circuit and a fire.

- Make sure that the plug of the electrical cord is not squeezed by the back wall of the appliance or otherwise damaged. A damaged plug can be the cause of a fire!

Positioning

- Place the appliance in a dry, well ventilated room.



WARNING! The appliance should not be operated in an unheated room or porch. Place the appliance away from heat sources such as kitchen stove/oven, radiators, or direct sunlight.

The rear wall of the refrigerator, in particular, the condenser and other elements of the cooling system must not contact other elements, which may damage them, (e.g. central heating pipes and the water supply pipes).



WARNING! The appliance must not touch any pipes for heating, gas or water supply, or any other electrical devices.

Minimum distances from the heat sources:

- from the electric gas and other ovens - 30 mm,
- from oil or coal fired ovens - 300 mm,
- from built-in ovens - 50 mm

If there is no possibility of ensuring the above- mentioned distances, provide an appropriate insulation board.

- Do not cover the ventilation holes at the top of the appliances – it must be a good air circulation around the appliance. There should be a gap of at least 10 cm between the top of the appliance body and any furniture that may be above it (see fig.). If this requirement is not followed, the appliance consumes more electrical energy and its compressor may overheat. ►
- The appliance must stand on a level surface and must not touch the wall. If necessary, regulate the height of the appliance by adjusting the levelling feet: by turning them clockwise – the front of the appliance rises, by turning them counter clockwise – it comes down. If the appliance is tilted slightly backward – the doors will close by themselves.

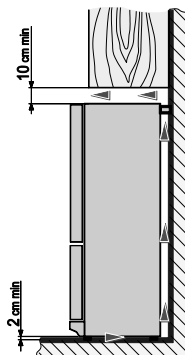
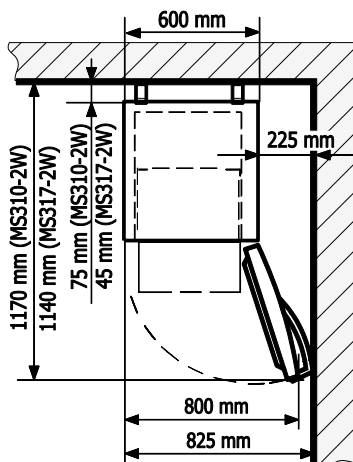

- If the appliance is placed in a corner, a gap must be left between the appliance body and the wall so that the freezer compartment door can be opened enough to pull out the frozen product drawer (see picture).

ELECTRONIC CONTROL PANEL DESCRIPTION.

TEMPERATURE REGULATION.

Model MS317-2W (fig. 1)

When connecting the device to the mains for the first time, the blue temperature indicating segment lights up at +5 (factory temperature setting +5 °C, but you can select the preferred temperature according to your needs).

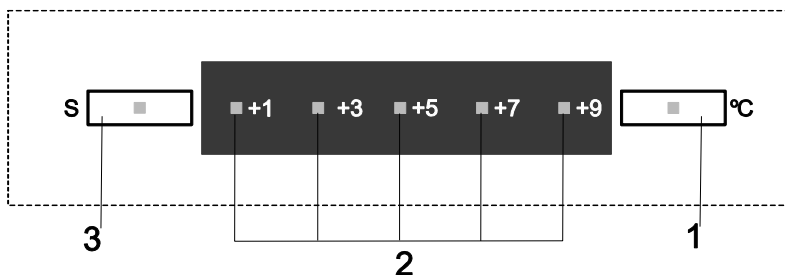

1. Temperature adjustment button is marked with the °C symbol.

Temperature setting in the refrigerator compartment

Activate temperature button **1**: tap and keep until the temperature indicating segment starts to flash in blue (active). Then release button **1** and tap repeatedly until the required temperature segment is blue (activated). One tap changes the temperature by one position.

The temperature setting operates in a circle: for example, the active segment is at +5, and if you want to set +9 °C after activation you have to tap temperature button **1** 2 times – until the temperature indicating segment at +9 turns blue.



Refrigerator compartment temperature is adjustable on a nine-point scale:

+9 – highest temperature (lowest cooling).

+1 – lowest temperature (highest cooling).

NOTE. After power loss the device turns on automatically, saving the last user-set temperature in the refrigerator compartment.



THE TEMPERATURE IN THE REFRIGERATOR COMPARTMENT MAY VARY DEPENDING ON AMBIENT TEMPERATURE, THE AMOUNT OF FOODSTUFFS, THE TEMPERATURE OF THE FOODSTUFFS, AND HOW OFTEN THE APPLIANCE DOORS ARE OPENED AND CLOSED. Therefore we recommend:

- locate the appliance away from heat sources,
- **do not put hot foodstuffs in the refrigerator compartment – they must be cooled down to room temperature,**
- appliance door must not be left open,
- the appliance door should not be open longer than it is necessary to take out or put in foodstuffs

IF THE REFRIGERATOR COMPARTMENT DOOR IS OPEN MORE THAN 30 SECONDS an audible warning signal sounds, and silencing when the door is closed.



IF THE ROOM TEMPERATURE IS BELOW +16 °C, we recommend that you set a lower temperature with the temperature-selection button (1).

Cooling device on/off

SHUTDOWN. Tap and hold button **1** until the three temperature indicative segments are blue, and the light in the refrigerator compartment turns off. **CAUTION!** Voltage remains turned on.

SWITCHING ON. Tap and hold button **1** until the set temperature indication segment is blue, and the refrigerator compartment lighting is on.

NOTE: after turning on the cooling device, the last temperature set by the user will be saved.

2. Temperature indicator segments. The temperature set-point segment is illuminated in blue (active), while the other temperature value segments are grey (inactive).

3. The FAST FREEZE function is activated by tapping button **3** marked with the "S" symbol. When the FAST FREEZE function is on, the white segment in the centre of the button is on.

We recommend using the FAST FREEZE function when you are going to freeze large quantities of fresh food. Turn on this function 24 hours in advance. Then put the food in the freezer compartment section marked with the symbol .

The FAST FREEZE function automatically shuts off when a temperature below -18 °C is achieved.

Model MS310-2W (fig. 2)

The temperature in the refrigerator compartment is controlled using the thermostat knob **1** (fig. 1) by turning it to one side or the other. The temperature indication in digits is shown beside the thermostat knob.

The temperature is regulated on the scale of seven digits:

0 = Compressor is switched off. **WARNING!** Electric current is not switched off.

1 = highest temperature (lowest cooling)

7 = lowest temperature (highest cooling)

If foodstuffs in the refrigerator compartment are too cold, set the thermostat knob to **1**, **2** or **3**. If foodstuffs in the refrigerator compartment are not being chilled sufficiently, set the thermostat knob to **4**, **5** or **6**. Please set the desired temperature in the appliance according to your own requirements.



IF THE ROOM IS COOL, THE APPLIANCE COOLS LESS. THE TEMPERATURE IN THE APPLIANCE MAY THEREFORE RISE. Use the thermostat wheel to set a lower temperature.

USING THE REFRIGERATOR-FREEZER EFFICIENTLY

Storage zones in the refrigerator

- Due to the natural circulation of the air in the appliance, there are different temperature zones in the refrigerator chamber.
- The coldest area is directly above the vegetables drawers. Use this area for all delicate and highly perishable food e.g.
 - Fish, meat, poultry
 - Sausage products, ready meals
 - Dishes or baked goods containing eggs or cream
 - Fresh dough, cake mixtures
 - Pre-packed vegetable and other fresh food with a label stating it should be kept at a temperature of approx. +4 °C.
- The warmest area is in the top section of the door. Use this for storing butter and cheese.

Food that should not be stored in a refrigerator.

Not all food is suitable for storing in the refrigerator, particularly:

- Fruit and vegetables which are sensitive to cold, such as bananas, avocado, papaya, passion fruit, aubergines, peppers, tomatoes and cucumbers.
- Fruit which is not yet ripe
- Potatoes
- Do not keep prepared food and ready-to-cook ("heat and eat") food in the same container.
- **Strictly observe the foodstuff validity time indicated by the manufacturer on the product packaging.**
- Store in an airtight container in the appliance any foodstuffs that have a strong odour (e.g. fresh fish, pâté de foie gras goose liver pâté, and cheese).
- Frozen foodstuffs should be thawed in the refrigerator compartment. Food that thaws slowly retains better flavour properties and spread cold will help to maintain the set temperature in the refrigerator compartment.



THE TEMPERATURE IN THE REFRIGERATOR COMPARTMENT MAY VARY DEPENDING ON AMBIENT TEMPERATURE, THE AMOUNT OF FOODSTUFFS, THE TEMPERATURE OF THE FOODSTUFFS, AND HOW OFTEN THE APPLIANCE DOORS ARE OPENED AND CLOSED. Therefore we recommend:

- locate the appliance away from heat sources,
- **do not put hot foodstuffs in the refrigerator compartment – they must be cooled down to room temperature,**
- appliance door must not to be left open,
- the appliance door should not be open longer than it is necessary to take out or put in foodstuffs.

Freezing of foodstuffs

Model MS317-2W (fig. 1)

When freezing large quantities of fresh food, turn on the FAST FREEZE function 24 hours in advance – tap FAST FREEZE function button **3** marked with symbol **"S"** (see Fig. 3). The segment in the centre of the button will light.

The FAST FREEZE function automatically shuts off when a temperature below -18°C is achieved. The light goes out in the centre of the FAST FREEZE button.

Place fresh food prepared for freezing in one or two lines in the rapid freezing compartment marked with the symbol .

After 24 hours, move the frozen food products from the FAST FREEZE section into the storage section drawer(s) (see Fig. 1).

Model MS310-2W (fig. 2)

When freezing large quantities of fresh food, the thermostat knob should be set to **7**. Place fresh food prepared for freezing in one or two lines in the rapid freezing compartment marked with the symbol .

After 24 hours the frozen food products should be replaced from the quick-freeze section to the storage section drawer(s) (Fig. 2). When the products are frozen, the thermostat wheel should be **set at its earlier position**.

- DO NOT EXCEED THE MAXIMUM AMOUNT OF FROZEN FOOD INDICATED IN THE PRODUCTS DATA SHEET.
- Leave not less than 3 cm gap between a top of frozen products and a bottom of drawer, which is over them.
- **Do not refreeze partly thawed products.**
- Do not place unwrapped foodstuffs in the freezer sections.
- Fresh food for freezing should not touch already frozen foodstuffs.
- Do not freeze foodstuffs that are warmer than the room temperature.
- WARNING! Do not freeze liquid foodstuffs in glass vessels or bottles.
- Do not consume ice made in the freezer compartment straight away.
- Products will freeze more quickly if they are divided up and packed in small portions.
- **Strictly observe the frozen foodstuffs validity dates indicated by the manufacturer on the product packaging.**



WE RECOMMEND THAT FROZEN FISH AND SAUSAGE SHOULD BE STORED IN THE FREEZER COMPARTMENT NOT LONGER THAN 6 MONTHS; CHEESE, POULTRY, PORK, LAMB – NOT MORE THAN 8 MONTHS; BEEF, FRUIT AND VEGETABLES – NOT LONGER THAN 12 MONTHS.

DEFROSTING

THE REFRIGERATOR COMPARTMENT defrosts automatically. Drops of ice that form on the back wall of the refrigerator compartment thaw during the time the compressor is not working and the thaw water runs down the thaw water runoff channel to the tray on top of the compressor (Fig. 1), where it evaporates.

Model MS317-2W (fig. 1)

FREEZER COMPARTMENT of gets defrosted automatically: it operates a frost-free cooling system (No Frost). However, according to how often the freezer door were opened and closed, and to - how warm products were placed into the appliance, the frost can accumulate on walls of freezer inner liner and drawers. It is normal. But the thicker is the layer of frost, the higher is a power consumption. In case if No Frost system had not managed to evaporate the excess moisture and the frost layer has formed on, you should defrost the appliance. To defrost the appliance, follow the steps in sequence:

- **WARNING!** Turn the appliance off and pull the plug out of the electrical socket.
- Remove foodstuffs from freezer compartment. The frozen foodstuffs will not warm up too much while you are thawing the freezer compartment if you cover them with a thick cloth and keep them in a cool place.
- Leave door of freezer compartment open. When the frost melts, clean and wipe dry the surfaces and fixtures of the freezer compartment.
- Close the appliance door. Plug in and turn on the appliance.

Model MS310-2W (fig. 2)

FREEZER COMPARTMENT of should be thawed not less than twice a year or when a layer of ice thicker than 5 mm forms in it. Do the actions below in the order they are listed:

IMPORTANT! Turn off the appliance – unplug the power supply cord plug from the electrical socket.

- Remove foodstuffs from freezer compartment. The frozen foodstuffs will not warm up too much while you are thawing the freezer compartment if you cover them with a thick cloth and keep them in a cool place.
- Remove the thaw water chamfer **10** (fig. 2), turn it 180 ° and place in front of the freezer compartment (Fig. 4). Place a bowl under the thaw water chamfer.

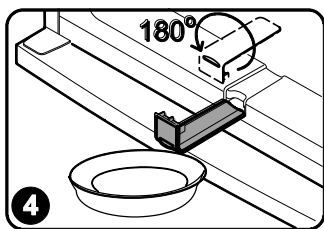

- Place a dish under the thaw water channel. Leave door of freezer compartment open.
- When the ice melts, clean and wipe dry the surfaces and fixtures of the freezer compartment.
- Remove the melt water channel, turn it by 180° again and put it back in its original place.
- Close the appliance door. Plug in and turn on the appliance.

CLEANING AND CARE

REGULARLY CLEAN THE APPLIANCE!



Note: before cleaning the cooling device and its rear compartment part, the device must be disconnected from the mains by unplugging.

- Protect the appliance inner surfaces and plastic parts from fats, acids and sauces. In case of accidental spills – immediately clean with warm soapy water or dishwashing detergent. Wipe dry.

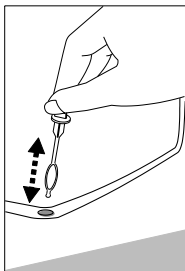

- Clean the appliance inner surfaces with warm soapy water. Dishwashing detergent may also be used.
- Wipe dry inner and outer surfaces.
- Regularly clean the hermetic gaskets of the doors. Wipe dry.
- Regularly wash the trays and other accessories.
- → REGULARLY CLEAN THE THAW WATER CHANNEL SPACE WITH A SPECIAL CLEANER FOR THAT PURPOSE (see picture).
- At least once a year clean dust away from the back part of the appliance body and the compressor. A soft brush, electrostatic cloth or vacuum cleaner may be used for cleaning.
- DO NOT use detergents containing abrasive particles, acid,

alcohol or benzene for cleaning the appliance inner and outer surfaces.

- DO NOT use for cleaning cloths or sponges that have coarse surfaces intended for scrubbing.
- IF THE APPLIANCE IS TO BE LEFT SWITCHED OFF FOR AN EXTENDED PERIOD, LEAVE ITS DOORS OPEN.



Remarks on the appliance operating noise. As the appliance operates and goes through the freezing cycle, various noises will be emitted. This is normal and is not a sign of any malfunction.

- As the refrigerant circulates around the refrigeration system, it causes sounds like murmuring, bubbling, or rustling.
- Louder sounds like popping or clicking may be heard for a short time as the refrigerator's compressor switches on.

CHANGING THE OPENING DIRECTION OF THE DOORS

It is recommended that changing the opening direction of the doors should be done with a helper. You will need two spanners No. 8 and No. 10 and a head screwdriver.



When changing the opening direction of the doors, YOU CAN NOT lay the refrigerator horizontally!

Do the actions below in the order they are listed:

WARNING! Turn off the appliance and pull the plug out of the electricity supply socket.

1. Remove the covers **c** from the body of the refrigerator and of the inner side of the door. Also remove the upper bracket **6** together with the nut and washers and the spacer under the bracket.
2. Remove the door of the refrigerator compartment **1**. Remove the stopper **5** from the bottom of it. On the other side of the door attach the stopper intended for doors that open on the left (you will find it in the packet).

3. Remove the middle bracket **4** together with the washers on the axle and the plastic spacer. Remove the freezer compartment door **3**.
4. Remove the bottom cover **11** together with the small cover **10**.
5. Remove the bottom bracket **2** together with the washers on the axle and the plastic spacer. Unscrew the axle with the washers and screw it into the aperture provided on the other side. Unscrew the bracket **7** and counterchange brackets **2** and **7**.
6. Remove plugs **8** from the partition wall, separating freezer and refrigerator compartments, and place them into holes on the opposite side.
7. Remove covers **a** of handle fixing screws and unscrew these screws. Transfer handles to the other side. Impress plugs **b** (you'll find them in package) into empty holes in doors.
8. Remove plug **9** of the freezer compartment door and impress it in the opposite side.
9. Hang the freezer compartment door **3** on the axle of bracket **2** on the opposite side of refrigerator.
10. Turn the bracket **4** together with plastic spacer at 180° and counterchange washers, located on axle, on top and bottom of the bracket. Having the bracket axle placed in door of freezer, screw it on the opposite side of refrigerator.
11. Hang the refrigerator compartment door on the axle of bracket **4**.
12. Turn the bracket **6** around 180° together with the washers on the axle and the plastic spacer. Remove the axle and the washers and reattach them on the other side of the bracket. Having the axle of bracket **6** placed into the door of refrigerator compartment door, screw the bracket into lower holes on the opposite side of refrigerator. Cover the bracket and remaining empty hole with covers **c**.
13. Place the cover **10** to the guides of the bottom cover **11** on the opposite side and place the bottom cover **11** in its former place.

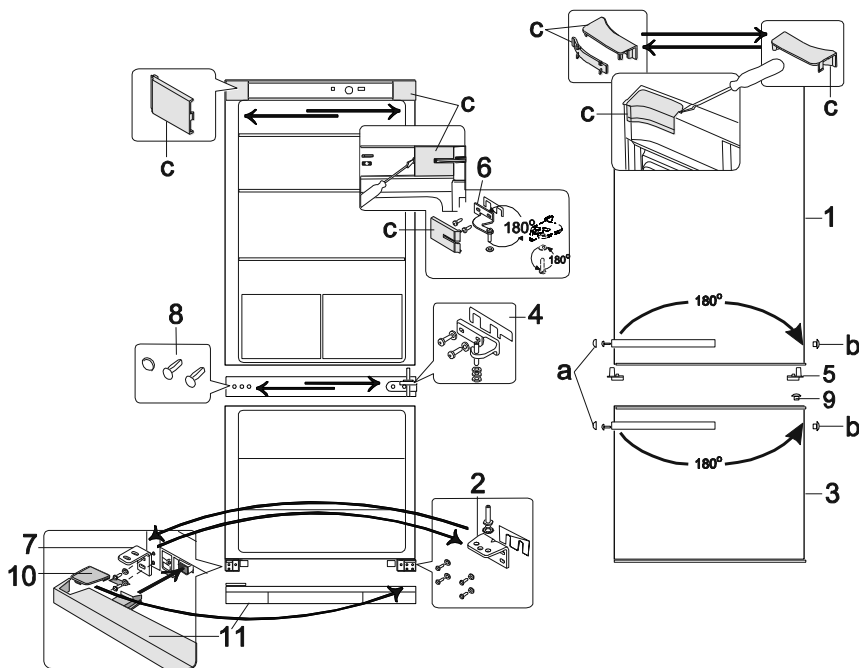

OPERATION PROBLEMS AND THEIR SOLUTIONS (TROUBLESHOOTING). What if ...

- **The appliance is plugged in to the mains but it does not work.** Check that your house electricity supply installations are in order. Check that the plug is correctly inserted into the electricity supply socket.
- **Model MS317-2W. Temperature segment in centre of button is red.** Cooling device is operating in emergency mode. Contact the refrigeration appliance's maintenance and repair company without delay.
- **Model MS317-2W. Temperature cannot be set, FAST FREEZE function cannot be activated.** Close the refrigerator door, turn off the cooling device –disconnect the power supply cord from the outlet, and wait 12 minutes. After the specified time, plug the power cord back into the outlet and perform the required action: set the temperature or turn on the FAST FREEZE function.
- **The noise has become louder.** Check that the appliance is standing stable, on a level place. To make it level, regulate the front feet. Check if the appliance is not touching any furniture, and that no part of the refrigeration system at the back part of the appliance body is touching the wall. Pull the appliance away from any furniture or walls. Check that the cause of increased noise isn't due to bottles, cans or dishes in the appliance that might be touching each other.
- **Water has appeared at the bottom of the refrigerator compartment.** Check whether a thaw water channel space isn't blocked. Clean the thaw water channel space with a cleaner intended for that purpose.
- **Water has appeared on the tempered glass shelves.** Food items or dishes in the refrigeration compartment are touching the back wall of the compartment. Do not let food items or dishes touch the back wall.
- **Moisture dripping from under the glass shelves.** If you placed many containers with liquids on the shelf, moisture can condense and drip onto the shelf below. Move some containers with liquids onto other shelves.
- **Water has appeared under the appliance.** The thaw water collection tray has slipped off the compressor. Place the tray on top of the compressor.
- **When the appliance door is opened, the rubber sealing gasket pulls out.** The gasket is smeared with sticky foodstuffs (fat, syrup). Clean the sealing gasket and the groove for it with warm water containing soap or dishwashing detergent and wipe dry. Put the rubber sealing gasket back into the place.
- **High temperature in appliance, the compressor operation pauses are short.** Ascertain whether the appliance doors are shutting tightly, whether the door wasn't kept open longer than necessary when taking out or putting in foodstuffs or whether a large amount of warm food was placed in the appliance.
- **The top of the appliance has condensation on it.** The ambient relative air humidity is above 70 %. Ventilate the room where the appliance stands and if possible remove the cause of the humidity.

TRANSPORT



THE MANUFACTURER WILL NOT BE RESPONSIBLE FOR ANY DAMAGE OF THE APPLIANCE THAT RESULTS FROM NON-COMPLIANCE WITH THE INSTRUCTIONS FOR TRANSPORTATION.

- The appliance should be transported in the vertical position.
- When being transported, the appliance should be protected from atmospheric conditions (rain, snow, dampness).
- The appliance should be firmly secured in place while being transported, to avoid slippage or any shocks in the transport vehicle.
- **If the appliance was transported not vertically, it may be connected to the mains after 4 hours at least. If this is not done, the appliance compressor may fail.**

ENVIRONMENTAL PROTECTION

Ozone layer protection

The refrigerants and foaming agents, which are 100% free of FCKW and FKW have been used for manufacturing our product. Therefore we are helping to protect the ozone layer and prevent the increase of greenhouse effects. Also, the innovative technology and environmentally friendly insulation help in reducing energy consumption.

Recycling of the packaging

Our packaging are made of environmentally friendly materials, which can be reused:

- The external packaging is made of cardboard/foil;
- The FCKW free shape of foamed polystyrene (PS);
- Polyethylene (PE) foils and bags.

ELIMINATION / DISPOSAL OF THE EQUIPMENT



If the appliance is no longer in use, cut the connecting cable off the used equipment before its scrapping. Also, remove the appliance lock or render it useless so that the appliance presents no danger to children while being stored for disposal. This appliance is marked with a symbol of the crossed out waste container in conformance with the European Directive 2002/96/EC. Such

marking informs that the equipment may not be kept together with other waste coming from the household after the period of its use. The user is obliged to dispose of the appliance at the waste collection point. The local waste collection points, shops and communal units form an appropriate system enabling the disposal of the equipment. Handling the used electrical and electronic equipment properly contributes to the avoidance of consequences harmful to the human health and natural environment, resulting from the presence of hazardous substances and improper storage and processing of such equipment.





Manufacturer's Declaration

The manufacturer hereby declares that this product meets the requirements of the following European directives: Low Voltage Directive **2014/35/EC**; Electromagnetic Compatibility (EMC) Directive **2014/30/EC**; *ErP Directive* **2009/125/EC** and has thus been marked with the symbol and been issued with a declaration of compliance made available to market regulators.

PRODUCT FICHE

Model	MS310-2W	MS317-2W
Category ¹	7 - Refrigerator-freezer	
Fridge net volume, L	191	208
Cold section net volume, L	-	21
Freezer net volume, L	119	74
Actual consumption will depend on how the appliance is used and where it is located		
Energy efficiency class ²	A++	A+
Annual energy consumption ³ , kWh/year	223	301
Climate class ⁵	N-ST	N-ST
Frost-free system	No	Yes
Star marking of frozen-food storage compartments ⁴	*/ ***	
Freezing capacity, kg / 24 h	8	6
Temperature rise time, h	20	15
Height / width / depth of product, cm	194,5 / 60 / 65	194,5 / 60 / 62
Noise level, dB(A) re1pW	41	
Construction	Freestanding	
Electrical Data: see in the product label		

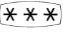
NOTE. The manufacturer reserves the right to make future changes to technical parameters and specifications.

- 1) 1 = Refrigerator with one or more fresh-food storage compartments,
 2 = Refrigerator-cellar, Cellar and Wine storage appliances,
 3 = Refrigerator-chiller and Refrigerator with a 0-star compartment,
 4 = Refrigerator with a one-star compartment, 5 = Refrigerator with a two-star compartment,
 6 = Refrigerator with a three-star compartment, 7 = Refrigerator-freezer,
 8 = Upright freezer, 9 = Chest freezer, 10 = Multi-use and other refrigerating appliances
- 2) A+++ (most efficient) to D (least efficient)
- 3) Annual energy consumption (AE C) in kWh per year, based on standard test results for 24 hours.
 Actual energy consumption will depend on how the appliance is used and where it is located.
- 4) 1  One-star compartment with nominal temperature of -6°C
 2  Two-star compartment with nominal temperature of -12°C
 3  Three-star compartment with nominal temperature of -18°C
 4  Food freezer compartment (four-star compartment) with nominal temperature of -18°C
- 5) Climate class: This appliance is intended to be used at an ambient temperature between lowest and highest temperature: SN = 10°C-32°C, N = 16°C-32°C, ST = 16°C-38°C, T = 16°C-43°C

Here For You

After-sales assistance

If you continue to experience problems with your Fridge Freezer, please call the Montpellier customer service helpline on: **01759 487839**

Please have all your product details available, including the model number, serial number, date of purchase, and your retailer's details before registering a fault.

The service call cannot progress without this information.

Your 2 year Manufacturer's guarantee

THIS DOES NOT AFFECT YOUR STATUTORY RIGHTS.

Your new Montpellier appliance carries a free guarantee which protects you against the cost of repairs during the first 24 months from date of purchase provided that:

Any claim is accompanied by evidence of the model reference, model serial number and proof of purchase, such as a Sales Receipt, showing that the appliance was purchased within the 24 months prior to the date of claim.

What is not covered under the Guarantee

- Any appliance not correctly installed and operated in accordance with the manufacturer's instructions.
- Any appliance that is used for anything other than domestic purposes.
- Any defect caused by accident, misuse, unauthorised modification or inexpert repair.
- Cost of Call-out where a fault cannot be found with the appliance.
- Cost of Call-out for work covering routine maintenance, such as, but not exclusively, cleaning of filters or defrosting.
- Cost of Call-out for work required to correct the alignment of doors following door reversal procedures carried out by you.
- Use of the appliance by anyone other than the Householder.
- Use in any commercial environment.
- Consumable items, such as, but not exclusively, fuses in plugs, bulbs and breakable items which require routine replacement.
- Repair costs incurred that have not been authorised by Montpellier and/or carried out by a non-approved Montpellier engineer.
- Montpellier Appliances do not accept claims for consequential loss, rusting, corroding, delivery damage or scratches.

YOUR GUARANTEE IS VALID ONLY IN THE UK.

To register your appliance simply complete the card in your appliance pack and return it with a stamp affixed or alternatively you can register online at **www.montpellier-appliances.com/support**

SERVICE HELP-LINE

Should your appliance develop a fault, please call the Montpellier customer service helpline on: **01759 487839**

Please remember to have all your product details available, including the model number, serial number, date of purchase and your retailer's details before registering a fault.

Montpellier Domestic Appliances Ltd.

Unit 1, Tewkesbury Retail Park, Northway Lane,
Tewkesbury, Gloucestershire GL20 8JU

www.montpellier-appliances.com



The symbol on the product or on its packaging indicates that this product may not be treated as household waste. Instead it shall be handed over to the applicable collection point for the recycling of electrical and electronic equipment. By ensuring this product is disposed of correctly, you will help prevent potential negative consequences for the environment and human health, which could otherwise be caused by inappropriate waste handling of this product. For more detailed information about recycling of this product, please contact your local city office, your household waste disposal service or the shop where you purchased the product.