

Montpellier

THE PERFECT BALANCE OF FUNCTION AND STYLE

LAUNDRY - DISHWASHING - COOKING - COOLING

Installation and Operating Instructions



Washer Dryer

MWD7512

White | Black | Silver

Please read these instructions carefully before attempting to install or use this appliance.
We recommend that you keep these instructions in a safe place for future reference.

Welcome

Thank you for choosing this Montpellier Washer Dryer.

Our Washer Dryer has been designed to provide you with the best combination of style, reliability and performance to give you years of trouble-free use.

You may be familiar with a similar product, but please take time to read these instructions carefully before installing or using your Washer Dryer to ensure you get the most from your purchase.

We recommend that you keep this manual in a safe place for future reference.

**2
YEAR
GUARANTEE**

— PARTS & LABOUR —

ACROSS ALL OUR MODELS

Montpellier

www.montpellier-appliances.com

Your Washer Dryer is covered by a comprehensive two year Parts & Labour Guarantee. In the unlikely event that you experience a problem with your Washer Dryer, you can rest assured that you are fully protected against the cost of repairs for the first 24 months. Please note that any claim must be accompanied by the model reference number, serial number and proof of purchase.

To activate your guarantee, you will need your product serial number. This can be found on the rear of the machine.

There are two ways to register your Guarantee:

- **Online:** Visit the Support page on our website and complete the online Product Registration form. www.montpellier-appliances.com
- **By Post:** Simply detach and fill in the form provided, attach a stamp and send it in the post. Don't forget to include your e-mail address so that we can send confirmation through to you.



Note: We are unable to take registrations over the phone.

What's Included with Your Washer Dryer

- 4 blanking caps.
- Fill hose.
- Guarantee registration leaflet – don't forget to activate your free 2 year guarantee. See the inside cover for further details.
- Liquid detergent level plate.

Contents

Putting Your Safety First **4**

Get to Know Your Washer Dryer **6**

Front View 6

Rear View 7

Setting Up Your Washer Dryer **8**

Guidance for Installing your Washer Dryer 8

Removing the Transportation Safety Screws 8

Levelling your Washer Dryer 9

Connecting your Washer Dryer to the water supply 9

Connecting the Drain Hose to your Washer Dryer 10

Connecting your Washer Dryer to the electrical supply 10

Control Panel Layout 11

Using Your Washer Dryer **11**

Detergent Drawer Compartments 12

Using your Washer Dryer for the first time 12

Getting the Best from Your Washer Dryer 12

Selecting a Programme 14

Taking Care of Your Washer Dryer **20**

Cleaning 20

Maintenance 20

Problem Solving **23**

Technical Specifications **25**

Product Fiche **26**

Here For You **27**

After-sales assistance 27

Your 2 year Manufacturer's guarantee 27

What is not covered under the Guarantee 27

SERVICE HELP-LINE 27

Putting Your Safety First



CAUTION: To ensure your safety and the safety of others, please read the following safety precautions before you operate your Washer Dryer.

- Your Washer Dryer conforms to current safety requirements. Inappropriate use can, however, lead to personal injury and damage to property. To avoid the risk of accidents and damage to your Washer Dryer, read this user guide carefully before using it for the first time. It contains important information on the installation, safety, use and maintenance of your Washer Dryer. Retain this user guide for future use and pass it on to any new owners.
- Read this user guide before using or installing your Washer Dryer.
- Your Washer Dryer is for domestic use only and is only intended to wash and dry items which are specified by the manufacturer to be machine washable and dryable on the label, and textiles composed of hand washable wool or wool blend fabrics as well as satin, lace, silk and other hand-washable garments. Do not use your Washer Dryer for any purpose not expressly specified in this user guide.
- This appliance can be used by children aged from 8 years and above and persons with reduced physical, sensory or mental capabilities or lack of experience and knowledge if they have been given supervision or instruction concerning use of the appliance in a safe way and understand the hazards involved. Children shall not play with the appliance. Cleaning and user maintenance shall not be made by children without supervision.
- Before setting up your Washer Dryer, check for any external visible damage. Do not install or use your Washer Dryer if it is damaged.
- Before setting up your Washer Dryer, remove the four transportation safety screws and the rubber washers from the back of the machine (refer to page 8).
- Some water may be left in your Washer Dryer as a result of quality checks during production. This will not affect the operation of your Washer Dryer.
- Before connecting your Washer Dryer, ensure that the information on the data plate (voltage and connected load) matches that of the mains electricity supply. If in doubt, consult a qualified electrician.
- Do not connect your Washer Dryer to the mains electricity supply using an extension lead.
- A damaged power cord/plug can cause fire or give you an electric shock. When damaged it must be replaced, this should only be done by qualified personnel.
- Make sure that the door of your Washer Dryer is not restricted and can be opened fully.
- Exhaust air must not be discharged into a flue which is used for exhausting fumes from appliances burning gas or other fuel.
- Make sure hoses and cables do not cause a trip hazard.
- Never remove the plug from the socket by pulling the cord. Always hold the plug.
- Never touch the power cord/plug with wet hands as this could cause a short circuit or electric shock.
- Do not touch your Washer Dryer if your hands or feet are wet.
- Do not keep flammable or explosive chemicals near your Washer Dryer.
- Faulty components must only be replaced by a suitably qualified Service Agent using genuine spare parts.
- Unauthorised repairs could result in unforeseen dangers for the user. Repairs should only be undertaken by an approved service agent.
- In the event of a fault or for cleaning purposes, your Washer Dryer is only completely isolated from the electricity supply when it is unplugged from the mains.
- Your Washer Dryer must only be connected to your water supply using the supplied new fill hose. Old hoses must not be reused.
- Do not make any alterations to your Washer Dryer, unless authorised to do so by Montpellier.
- The packaging of the machine could be hazardous to children. Do not allow children to play with the packaging or small parts from the Washer Dryer. Please refer to the disposal instructions on the rear cover.
- Do not climb on your Washer Dryer.
- Do not turn your Washer Dryer upside down or on its side.
- Do not lift your Washer Dryer using the door or detergent drawer.
- Please ensure that you have removed all of the packaging materials and protective tape from the outside of your Washer Dryer, inside the drum and inside the detergent drawer before using.

Putting Your Safety First

- Do not exceed the maximum load for the washing or drying programme you have chosen.
- Never force the door open when your Washer Dryer is running.
- Never open the detergent drawer while the machine is running.
- Thoroughly rinse off any chemicals such as stain remover from your garments before beginning a washing and drying programme.
- Please follow the manufacturers' instructions regarding the use of fabric conditioner or any similar products that you intend to use in your Washer Dryer.
- Residue may build up on detergent and softeners exposed to air for a long period of time.
- Only put softener or detergent in the drawer at the beginning of each wash.
- Please ensure that garments loaded into your Washer Dryer are free from foreign objects such as nails, needles, lighters and coins.
- Do not stop your Washer Dryer before the drying phase of a programme has been completed.
- Do not touch the door, drain hose or any discharged water while your Washer Dryer is running. The high temperatures involved pose a burn risk.
- Do not use a detergent ball/device if you have selected a washing and drying programme as this may cause a fire hazard.
- Open the drum door fully after the drying process. Do not touch the door glass. It will reach high temperatures and pose a burn risk.
- Clean the lint trap regularly.
- The necessary ambient temperature for operation of your Washer Dryer is 15-25 °C.
- Where the temperature is below 0 °C, hoses may split or the electronic card may not operate correctly.
- Unplug your Washer Dryer and switch off the water supply if the Washer Dryer is left unused for a long time. We also recommend that you leave the door open to prevent build up of humidity inside the Washer Dryer.



WARNING: Do not dry your laundry under the conditions specified below as they present a fire risk:

- If the laundry is not washed.
- If oil based stains are not pre-treated before beginning a washing or drying programme.
- Laundry that has a high amount of sponge, foam, rubber or rubber like parts and accessories.
- Rubber, sponge, latex, shower bonnets, watertight textile products, rubber based objects and clothes or pillows filled with rubber sponge must not be dried in your Washer Dryer.

Get to Know Your Washer Dryer

Front View

Figure 1

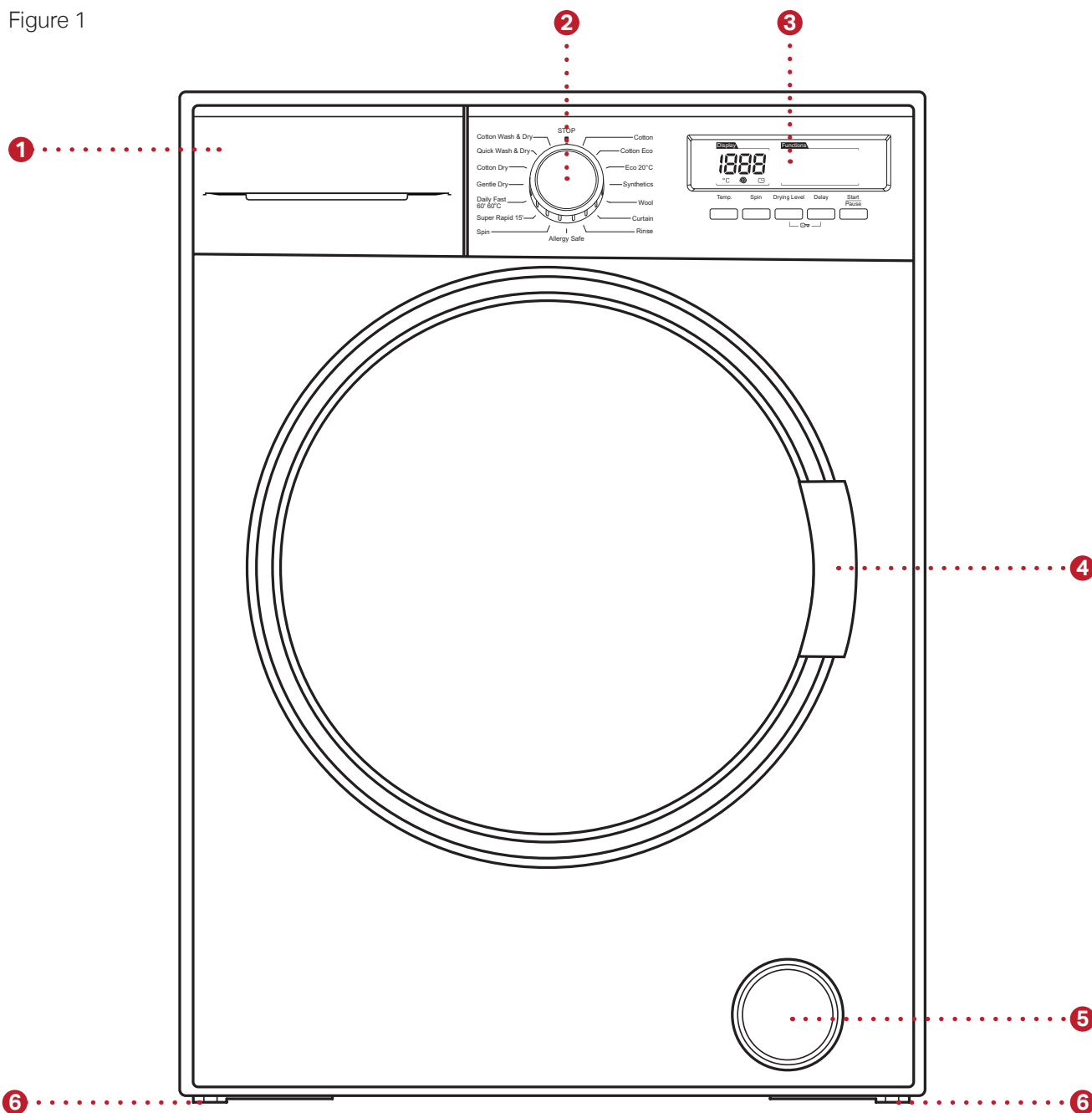

- 1** Detergent Drawer – for inserting detergent and fabric conditioner. Contains 3 compartments:
 - Main Wash.
 - Softener.
 - Pre-Wash.
- 2** Programme Dial – for selecting a washing and/or drying programme.
- 3** Control Panel – for configuring and viewing programme settings.
- 4** Door Handle - for access to the drum.
- 5** Pump Filter Cover – for access to the pump filter (for maintenance purposes only).
- 6** Adjustable Feet (x4) – for adjusting the level and height of your machine.

Get to Know Your Washer Dryer

Rear View

Figure 2

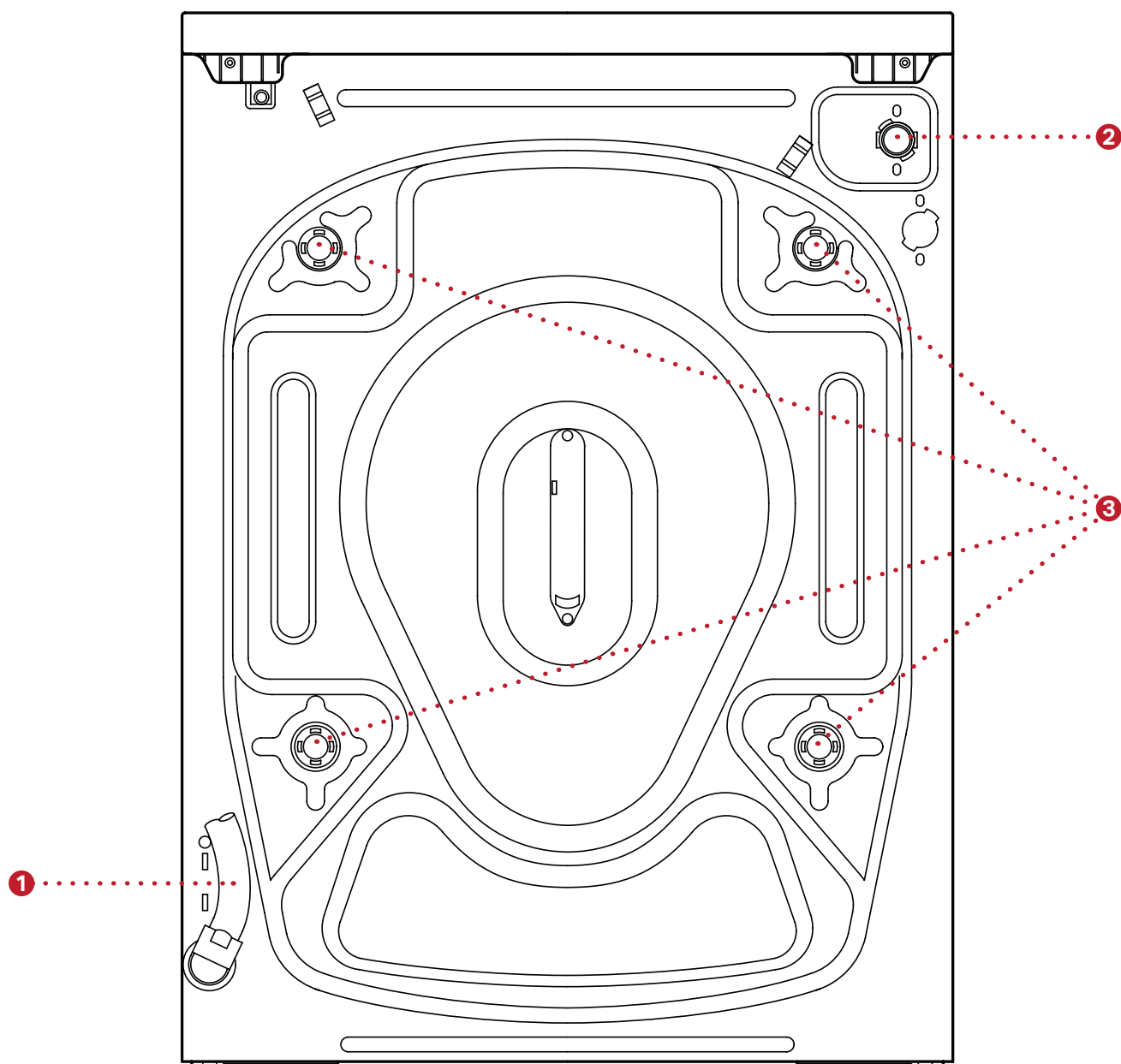

- ❶ Transportation Safety Screws (x4): These must be removed before using your Washer Dryer (see page 8).
- ❷ Water supply connection – for connecting your Washer Dryer to the cold water supply.
- ❸ Drain hose connection – for draining dirty water from your Washer Dryer.

Setting Up Your Washer Dryer

Guidance for installing your Washer Dryer

We recommend that you follow the guidance below when selecting a suitable location to install your Washer Dryer.



WARNING: Risk of injury. Your Washer Dryer is heavy and we strongly recommend that it is moved by a minimum of two people.



Note: The dimensions of your Washer Dryer are 85 x 60 x 60 cm. Make sure that the installation area has sufficient space to accommodate your appliance.

- ✓ Install your washer Dryer in an area that will allow the door to fully open.
- ✓ Make sure your Washer Dryer is located close to electrical and plumbing connections.
- ✓ We recommend installing your Washer Dryer on a concrete floor and if possible in the corner of the room. This will provide the greatest stability.
- ✗ Do not install your Washer Dryer on a soft surface such as carpet or rug.
- ✗ Do not install your Washer Dryer in an area where the temperature may drop below freezing. If hoses freeze they may split or burst.



Note: If you have to install your Washer Dryer on a wooden floor, we recommend the installation of a water resistant wooden base with a minimum thickness of 30 mm. Ideally the base should be bolted down and span several joists.

Removing the Transportation Safety Screws



CAUTION: Before operating your Washer Dryer, the transportation safety screws **must** be removed. Failure to do so may cause damage to your machine and will invalidate your guarantee.

There are four transportation safety screws located on the rear of your Washer Dryer (as shown in Figure 3). They are used to protect your Washer Dryer from damage during transportation and must be removed before first use. Please keep them in a safe place and re-fit them if transporting your Washer Dryer in the future.

To remove the transportation safety screws:

- 1 Using a suitable spanner, rotate each safety screw anti-clockwise until loose, and remove (see Figure 3(a)).
- 2 Pull out the remaining plastic sections of each screw by hand (see Figure 3(b)).
- 3 Insert the blanking caps into the four holes. Push the cap until the connectors click into place. When fitted correctly, the cap will be flush with the machine.

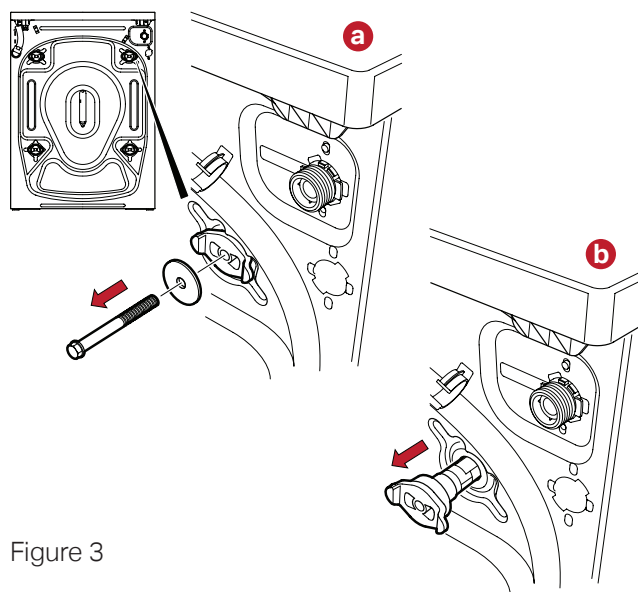

Figure 3

To refit the transportation safety screws for transportation:

- 1 Remove each of the four blanking caps.
- 2 Insert the plastic sections of the safety screws into the four holes.
- 3 Position the safety screws into the plastic sections inserted in step 2 and use a suitable spanner to tighten until secure.

Setting Up Your Washer Dryer

Levelling your Washer Dryer

Your Washer Dryer is supported by four adjustable feet. Adjust the feet as necessary to ensure that your appliance is level and secure:

- 1 Turn the plastic locking nut anti-clockwise to loosen (see Figure 4(a)).
- 2 Turn the feet clockwise to increase the height of the Washer Dryer (see Figure 4(b)).
- 3 Turn the feet anti-clockwise to decrease the height of the Washer Dryer (see Figure 4(b)).
- 4 Once the Washer Dryer is level, turn the plastic locking nuts clockwise to tighten (see Figure 4(c)).

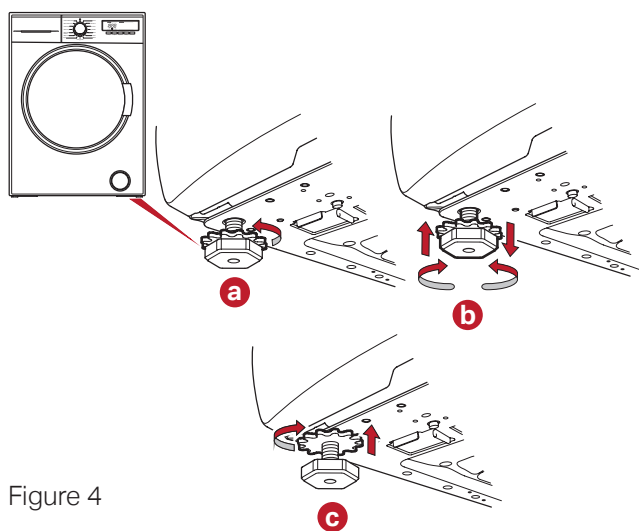

Figure 4

Connecting your Washer Dryer to the water supply

Your Washer Dryer must be connected to the cold water supply only. This increases efficiency as only the minimum amount of water required to wash your laundry is heated.



Note: If your previous machine had a hot water connection, we recommend that you check the hot tap on your water supply is closed to prevent leakage.

To connect your Washer Dryer to the cold water supply:

- 1 Connect the angled end of the fill hose to the cold water inlet at the rear of the Washer Dryer by screwing clockwise until hand tight (see Figure 5).
- 2 Connect the straight end of the fill hose to a 19 mm (3/4") cold water tap by screwing clockwise until hand tight.



Note: Make sure that the fill hose is not trapped, kinked or cross-threaded.

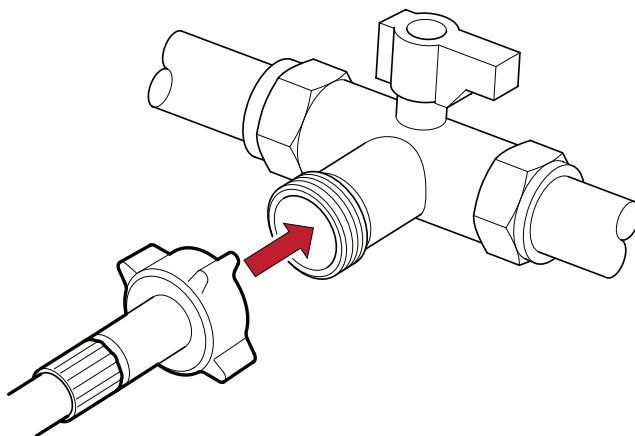

Figure 5

Setting Up Your Washer Dryer

Connecting the Drain Hose to your Washer Dryer

Your Washer Dryer can be connected to your household drainage system in one of two ways:

- 1 The drain hose can be connected to a standpipe (see Figure 6(a)).
- 2 The drain hose can be connected to a household sink (see Figure 6(b)).



Note: In either option the drain hose must be between 0 cm and 80 cm from the ground.

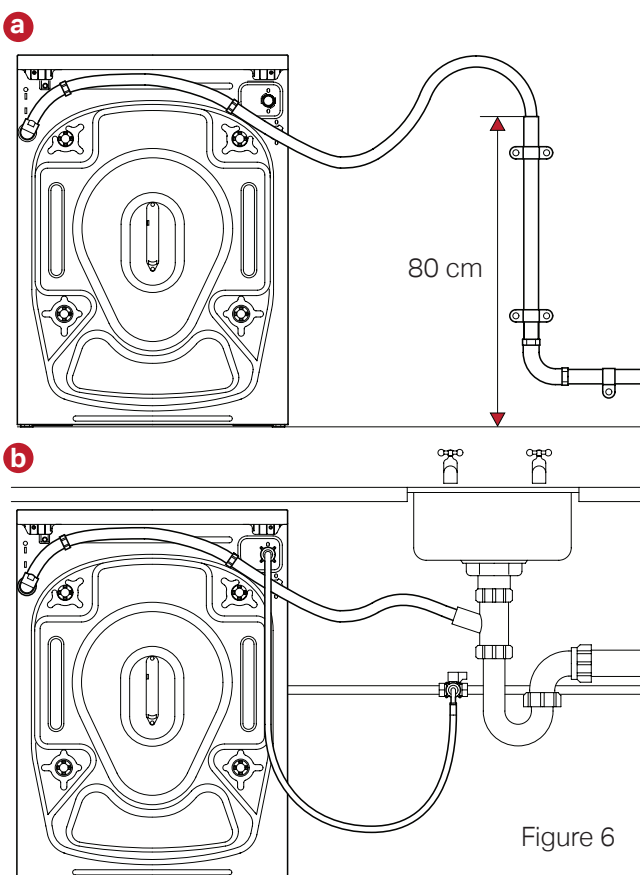

Figure 6



CAUTION: Make sure the drain hose is not trapped, twisted, folded or crushed. Do not attempt to extend the drain hose by adding extra sections.

We recommend that once you have connected your Washer Dryer to the water supply, you slowly turn your cold water supply on to check for any leaks.

Connecting your Washer Dryer to the electrical supply

To connect your Washer Dryer to the mains power supply:

- 1 Plug your Washer Dryer into a suitable mains supply.



Note: Your Washer Dryer runs on a 220-240 V, 50 Hz mains supply. Do not use any other supply.

Please note the following:

- The moulded plug fitted to your Washer Dryer cannot be re-wired.
- If you notice any damage to the plug or fuse cover do not use your Washer Dryer.
- If replacement fuses are required they should be ASTA-approved to British Standards and have the correct 13 Amp rating.

If you are in any doubt over whether your mains supply is suitable or require any repair work to be carried out please consult a qualified electrician.

Using Your Washer Dryer

Control Panel Layout

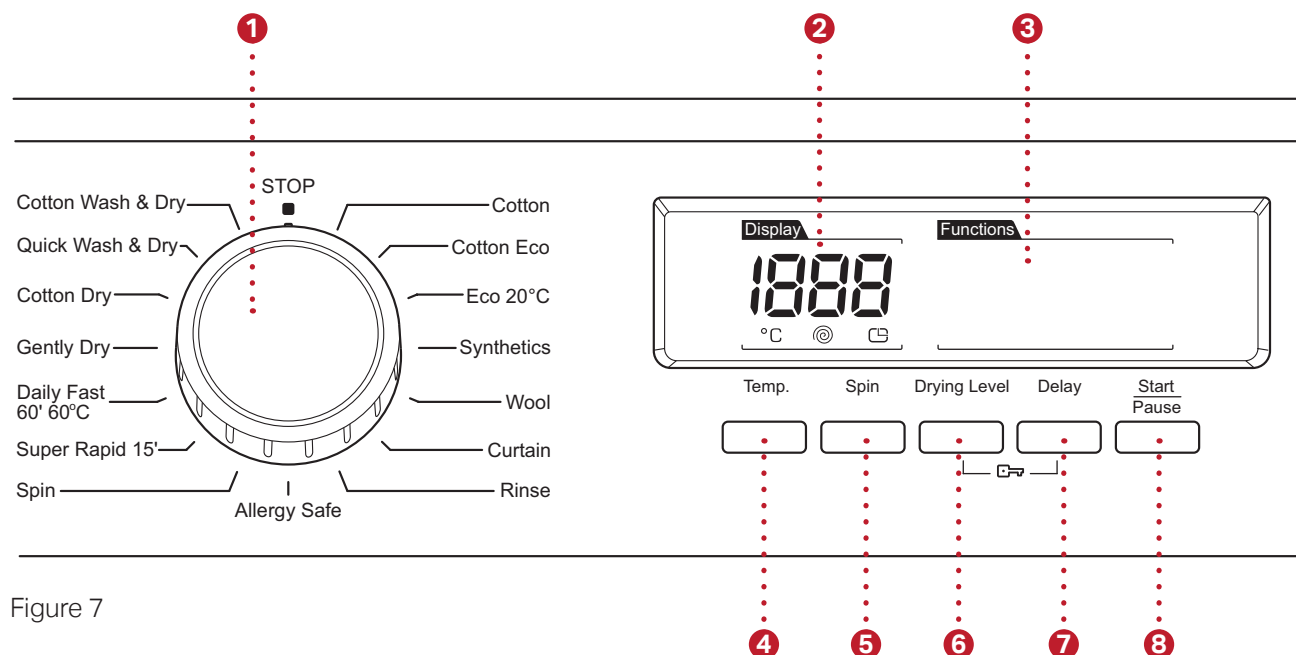

Figure 7

- 1** Programme Dial – for selecting a wash and/or dry programme (see Programme Tables on pages 14-16)
- 2** Digital Display - displays water temperature, spin speed, programme status, and the Child Lock status (also displays error codes, see page 24).
- 3** Function Display – displays:
 - the drying level selection
 - whether the delay timer is active
 - whether a programme is in operation or has been paused.
- 4** Temperature Adjustment Button – for adjusting the wash temperature.
- 5** Spin Speed Adjustment Button – for adjusting the spin speed (RPM) or switching the spin option off.
- 6** Dry Level Button – for selecting a drying level.*
- 7** Delay Start Button- for delaying the start time of the selected programme.*
- 8** Start/Pause Button – starts or pauses the selected programme.

*Press and hold buttons 6 and 7 for 3 seconds to activate and deactivate Child Lock.

Using Your Washer Dryer

Detergent Drawer Compartments

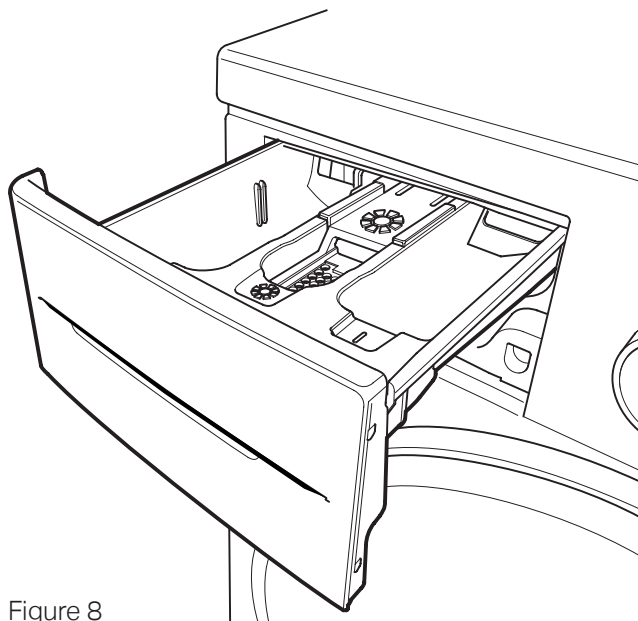



Figure 8

- 1 Main Wash Detergent Compartment: add detergent for the main wash.
- 2 Softener Compartment  for fabric conditioner and liquid starch.
- 3 Pre-Wash Detergent Compartment: only add detergent to this compartment for pre-wash cycles.

Using your Washer Dryer for the first time

Before using your Washer Dryer for the first time, it is important to check that:

- The transportation safety screws have been removed (see page 8)
- The fill hose and drain hose have been correctly connected to your Washer Dryer and to your water supply and drainage system and there are no leaks.
- Your Washer Dryer has been connected to a suitable mains power supply and is switched on at the socket.



Note: There may be some water left in your machine from the factory tests. This is quite normal and there is no cause for concern.

To remove any water, and to flush out any residue from factory tests, we recommend running a wash without any laundry:

- 1 Open the detergent drawer and add half a measuring cup of detergent to the main compartment. If you are using a liquid detergent, please refer to Adding Detergent on page 13 for more details.
- 2 Close the detergent drawer and turn the programme dial to select Cotton.
- 3 Close the door until it clicks shut.
- 4 Press the Start/Pause button to begin the empty wash cycle.

Getting the Best from Your Washer Dryer

To achieve the best results for your washing, we recommend you follow the steps below.



CAUTION: Always check your laundry items for foreign objects, such as coins or paper clips, before placing them in the machine. They can cause damage to your garments and to your Washer Dryer.

Preparing Your Laundry

Before placing laundry in the Washer Dryer:

- Make sure all garment pockets are empty, and any sand or dirt from pockets and cuffs has been brushed out.
- Close zips and fasten any hooks and eyes.
- Turn items, such as trousers, t-shirts, sweat shirts and knitted garments inside out.
- Remove any weights from curtains, or place inside a laundry bag.
- Remove, or sew in, any loose wiring in bras or shirt collar stiffeners.

Using Your Washer Dryer

Sorting Your Laundry

- ✓ Sort your laundry by colour - wash whites and coloureds separately.
- ✓ Wash dark garments separately several times before including them in a mixed load as they may contain excess dye.
- ✓ Follow all instructions given on clothing care labels.
- ✓ Follow the manufacturer's instructions to pre-treat soiled or stained clothing with a liquid detergent or stain-remover before washing.
- ✓ If using a solvent-based cleaning agent to pre-treat a stain, protect any plastic parts such as buttons. Rinse off the cleaning agent before loading the washing.
- ✗ Do not use a solvent-based cleaning agent in your Washer Dryer.
- ✗ Do not use your Washer Dryer to wash items that the care label has specified as non-washable.

Loading Your Laundry

- 1 Open the door by pulling the handle.
- 2 Loosely pack your laundry into the drum. We recommend you mix large and small items. This will help to distribute the load evenly during spinning and provide you with the best wash results.
- 3 Gently push the door until you hear it click shut. Ensure no items are trapped between the door seal and the door.



Note: Take care not to exceed the maximum load of the drum as this will produce poor wash results. See pages 14-16 for more information on load capacities).

Half Load Detection System

Your Washer Dryer has been designed to detect if less than half the maximum capacity of laundry is loaded into the drum. In such cases, the half-load function will automatically set, meaning the selected programme will take less time to complete and will use less water and energy.

Adding Detergent

For best wash results ensure the correct amount of detergent is added to your Washer Dryer.

If not enough detergent is added:

- Your laundry will not wash properly and may become discoloured and stiff over time.
- Fat stains may appear on your garments.
- Limescale may form on the heater elements.

If too much detergent is added:

- Excess foam will form which will result causing poor wash results.
- Your Washer Dryer will use more water.

Any detergent produced for automatic Washer Dryers can be used in your machine. We recommend the use of dispensing aids, such as balls, if they have been supplied with the detergent.

Tablets are suitable for full loads; it is impractical to reduce them for smaller loads. Some tablets are not suitable for shorter wash cycles as they do not dissolve as quickly as others.

Liquid detergent may be used for all programmes without a pre-wash. Slide the liquid detergent level plate into the main compartment of the detergent drawer (see Figure 9), and use the lines on the plate as a guide to add your detergent to the required level. Follow the manufacturer's guidelines on your detergent packaging to ensure you use the correct amount of detergent – this will depend on the dirtiness of your clothes and the hardness of your water supply.

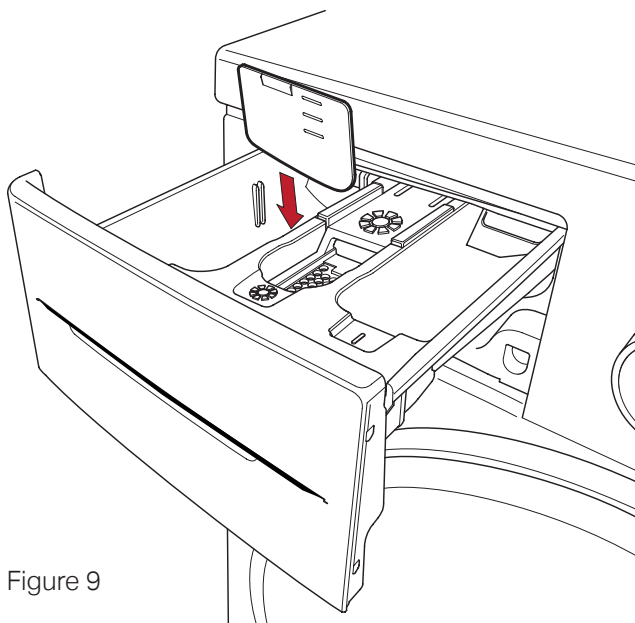



Figure 9

Using Your Washer Dryer

Do not pre-wash your laundry if it is only slightly soiled. Add an amount of detergent, as specified by the manufacturer, into the main compartment of the detergent drawer.

Select a programme with pre-wash if your clothes are excessively soiled. Add 1/4 of the detergent to be used into the pre-wash compartment of the detergent drawer and put the rest into the main compartment.

In areas of hard water, you can reduce the amount of detergent required with the aid of a water softener. Please follow the manufacturer's instructions on the amount of softener to use. Add the water softener after you have added detergent.

You can use fabric conditioner or liquid starch by adding the amount as instructed on the packaging to the softener  compartment of the detergent drawer. Do not exceed the MAX level stated.

Fabric conditioner is used to soften garments, while liquid starch is used to stiffen and give body to items, such as bedding.

Selecting a Programme

To select a programme:

- 1 Turn the programme dial clockwise or anti-clockwise until the marker on the dial aligns with the desired programme.

Delay Start Timer

Your Washer Dryer is equipped with a delay function. This provides you with the option of setting the programme to automatically start after a set period of time. The delay time can range from 1-23 hours.

To set a Start Delay time:

- 1 Press the Delay Start button. '1 h' will be displayed on the control panel and the  symbol will flash.
- 2 Press the Delay Start button until the desired delay time is shown on the control panel.
- 3 Once the desired delay time is shown on the control panel, press any button on the control panel other than the Start/Pause.



Note: To cancel a time delay function, press the Delay Start button once.

- 4 To activate the Delay Start function, press the Start/Pause button.

Starting a Programme

To start a selected programme, press the Start/Pause button.

Pausing a selected programme

To pause a running programme, press the Start/Pause button. The  symbol on the control panel will flash.

To resume a paused programme, press the Start/Pause button. The programme will resume from the current point in the cycle.

Programmes

Your Washer Dryer has 15 built in programmes to suit your washing and drying needs. Please use the information in the following tables to help you select the most suitable programme.



Note: * indicates factory default settings
-- represents cold water

Cotton	
Selectable washing temperatures (°C)	30, 40, 50, 60, 70, 80, 90*
Maximum washing/drying capacity (kg)	7/5
Detergent drawer	
Programme duration (minutes)	185
Recommended laundry type/Comments	Heat resistant cotton and linen, underwear bedding and tablecloths. Towels (max 3.5 kg).

ECO 60 °C	
Selectable washing temperatures (°C)	30, 40, 50, 60*
Maximum washing/drying capacity (kg)	7/5
Detergent drawer	
Programme duration (minutes)	205
Recommended laundry type/Comments	Heat resistant cotton and linen, underwear bedding and tablecloths. Towels (max 3.5 kg).

Using Your Washer Dryer

ECO 20°C

Selectable washing temperatures (°C)	--, 20*
Maximum washing/drying capacity (kg)	3.5/3.5
Detergent drawer	
Programme duration (minutes)	105
Recommended laundry type/Comments	Less dirty cotton and linen textiles, bedding and tablecloths. Towels (max 2 kg).

Synthetics

Selectable washing temperatures (°C)	--, 30, 40, 50, 60*
Maximum washing/drying capacity (kg)	3.5/3.5
Detergent drawer	
Programme duration (minutes)	122
Recommended laundry type/Comments	Synthetic and synthetic mixed textiles (synthetic content shirt, blouses, socks etc).

Wool

Selectable washing temperatures (°C)	--, 30*
Maximum washing/drying capacity (kg)	3.5/3.5
Detergent drawer	
Programme duration (minutes)	122
Recommended laundry type/Comments	Woollen and wool mix laundry specified as machine washable on the label.

Curtain

Selectable washing temperatures (°C)	30, 40*
Maximum washing/drying capacity (kg)	2.5
Detergent drawer	
Programme duration (minutes)	115
Recommended laundry type/Comments	For washing curtains only.

Rinse

Selectable washing temperatures (°C)	--
Maximum washing/drying capacity (kg)	7/5
Detergent drawer	-
Programme duration (minutes)	43
Recommended laundry type/Comments	Use for additional rinsing after washing.

Allergy Safe

Selectable washing temperatures (°C)	--, 30, 40, 50, 60*
Maximum washing/drying capacity (kg)	3.5/3.5
Detergent drawer	
Programme duration (minutes)	180
Recommended laundry type/Comments	Baby clothes specified as machine dryable on the label.

Spin

Selectable washing temperatures (°C)	--*
Maximum washing/drying capacity (kg)	7/5
Detergent drawer	
Programme duration (minutes)	20
Recommended laundry type/Comments	Use for additional spinning after washing. Suitable for all types of laundry specified as machine dryable on the label.

Using Your Washer Dryer

Super Rapid 15'

Selectable washing temperatures (°C)	--, 30*
Maximum washing/drying capacity (kg)	2/2
Detergent drawer	
Programme duration (minutes)	15
Recommended laundry type/Comments	For washing less dirty cotton, coloured and linen textiles in as a little as 15 minutes. As the washing time is short, less detergent is required than in other programmes. If your Washer Dryer detects an unbalanced load, the programme duration will increase.

Cotton Dry

Selectable washing temperatures (°C)	--*
Maximum drying capacity (kg)	5
Detergent drawer	
Programme duration (minutes)	60
Recommended laundry type/Comments	Cotton laundry specified as machine dryable on the label.

Daily Fast 60° / 60'

Selectable washing temperatures (°C)	--, 30, 40, 50, 60*
Maximum washing/drying capacity (kg)	3/3
Detergent drawer	
Programme duration (minutes)	15
Recommended laundry type/Comments	Dirty cotton, coloured and linen textiles.

Quick Wash & Dry

Selectable washing temperatures (°C)	--, 30*
Maximum washing/drying capacity (kg)	0.5/0.5 (3 shirts)
Detergent drawer	
Programme duration (minutes)	33
Recommended laundry type/Comments	Cotton, coloured and linen laundry specified as machine dryable on the label. Your Washer Dryer calculates the programme duration based on the load.

Gentle Dry

Selectable washing temperatures (°C)	--*
Maximum drying capacity (kg)	3.5
Detergent drawer	
Programme duration (minutes)	60
Recommended laundry type/Comments	Delicate laundry specified as machine dryable on the label.

Cotton Wash & Dry

Selectable washing temperatures (°C)	--, 30, 40, 50, 60*, 70, 80, 90
Maximum washing/drying capacity (kg)	5.5/5.5
Detergent drawer	
Programme duration (minutes)	285
Recommended laundry type/Comments	Cotton and linen textiles (underwear, bedsheets and tablecloths).

Using Your Washer Dryer

Adjusting the temperature

When you select a programme, a default water temperature is set and is displayed on the control panel. You can adjust this temperature by repeatedly pressing the Temperature Adjustment button until the desired temperature is displayed. The programme tables on pages 14-16 list the available temperatures for each programme.

You may find the table below helpful in selecting the desired temperature:

Temperature °C					
--	30	40	50	60	90
Cold water, used for rinsing.	The minimum recommended wash temperature. Efficient when used with a detergent suitable for this temperature.	The most common wash temperature. This is suitable for many everyday items.	Suitable for items such as polyester/cotton mixtures and nylon.	Recommended for bed linen and towels or highly soiled laundry such as baby clothes.	The maximum available temperature on your Washer Dryer. Suitable for white cottons/linen that show dirt.

Adjusting the spin speed

When you select a programme, the maximum spin speed is set and displays on the control panel. You can decrease this speed by repeatedly pressing the Spin Speed Adjustment button until the desired speed is displayed. Your Washer Dryer will automatically override a speed that is unsuitable for the selected programme.



Note: Selecting -- cancels any spin speed adjustment settings.

The table below lists recommended spin speeds for common clothing types:

Spin Speed (RPM)		
600	800	1200
Delicates Shirts Woollens	Denim	Cottons Dark garments

Dry Level selection



If you would like to dry your laundry once a washing programme has finished, press the Dry Level button to select a drying level. The symbol displayed on the control panel indicates the drying level selected along with the spin speed. Repeatedly press the Dry Level button to cycle through the available options for the selected programme.

You can delay the start of the drying cycle by pressing the Dry Level button until  is displayed along with the delay time. The available delay times are 30, 60 and 120 minutes.



































Note: If a delay time has been selected and no other button has been pressed, the display will revert back to the spin speed after a few seconds.

The table below shows suitable load weights for each drying level:

 (Level 1)	Suitable for loads of 1-4 kg
 (Level 2)	Suitable for loads of 3-5 kg
 (Level 3)	Suitable for loads of 3-5 kg

Using Your Washer Dryer

The tables below show the selectable drying levels and durations for each programme.

Programme	Selectable Yes/No	Drying Profile	Factory setting	Selectable Levels		
Cotton	Yes	Cotton Dry	-			
Cotton Eco	Yes	Cotton Dry	-			
Eco 20 °C	Yes	Cotton Dry	-			-
Synthetics	Yes	Gentle Dry	-			
Wool	No	-	-	-	-	-
Curtain	No	-	-	-	-	-
Rinse	Yes	Cotton Dry	-			
Allergy Safe	Yes	Cotton Dry	-			-
Spin	Yes	Cotton Dry	-			
Super Rapid 15'	Yes	Cotton Dry	-		-	-
Daily Fast 60° / 60'	Yes	Cotton Dry	-			-
Gentle Dry	Yes	Gentle Dry				-
Cotton Dry	Yes	Cotton Dry				-
Quick Wash and Dry	No	Cotton Dry		-	-	-
Cotton Wash and Dry	Yes	Cotton Dry				-

Programme	Selectable drying duration times (minutes)		
Cotton	30	60	120
Cotton Eco	30	60	120
Eco 20 °C	30	60	120
Synthetics	30	60	120
Wool	-	-	-
Curtain	-	-	-
Rinse	30	60	120
Allergy Safe	30	60	120
Spin	30	60	120
Super Rapid 15'	30	60	120
Daily Fast 60°/60'	30	60	120
Gentle Dry	30	60	120
Cotton Dry	30	60	120
Quick Wash and Dry	-	-	-
Cotton Wash and Dry	30	60	120

Using Your Washer Dryer

Child Lock

To activate the child lock, press and hold both the Dry Level and Delay Start button for 3 seconds. The control panel is locked. **LL** flashes 3 times if a selection is attempted.

To deactivate the child lock, press and hold both the Dry Level and Delay Start buttons for 3 seconds. **LL** flashes 3 times to indicate that the child lock has been deactivated.

Cancelling a selected programme

To cancel a running programme:

- 1 Turn the programme dial so that the marker on the programme dial is in the STOP position.
- 2 Turn the programme dial to select any programme. Any excess water remaining from the cancelled programme will be discharged.

Programme End

Once the selected programme has finished, your Washer Dyer will automatically stop and End will be displayed on the control panel.

To remove your laundry:

- 1 Turn the programme dial so that the marker on the programme dial is in the STOP position. The door lock will be automatically released approximately 2 minutes after the programme has ended.
- 2 Gently pull the door handle forward and fully open the door.
- 3 Remove all laundry from the drum and check that all items have been removed.
- 4 Leave the door open to allow the drum to dry.

Taking Care of Your Washer Dryer

To make sure that your Washer Dryer operates as intended, we recommend that you regularly carry out routine maintenance.

Before cleaning or carrying out any maintenance on your Washer Dryer:

- 1 Turn the mains power supply off and remove the plug from the socket
- 2 Turn the cold water supply off

Cleaning



CAUTION: Do not use solvents, abrasive cleaners, glass cleaners or all-purpose cleaning agents to clean your Washer Dryer. The chemicals they contain may damage the plastic surfaces.

The table below describes the recommend methods of cleaning the different parts of your Washer Dryer:

Drum	Use a suitable stainless steel cleaning agent, following the manufacturer's guidelines.
External casing	Use a mild, non-abrasive cleaning agent or soap and water. Wipe dry with a soft cloth.
Internal deposits – these deposits may build up when washes are mainly carried out at low temperatures.	Carry out a hot wash at 70 °C or above once every 4-6 weeks.

Maintenance

Water Inlet Filters

The water inlet filters are located on the rear of the machine and are designed to stop dirt and any other unwanted materials from entering your Washer Dryer. These filters may need cleaning when if your Washer Dryer does not receive sufficient water from the supply even though the tap is open and the supply is on.

To clean the water inlet filters:

- 1 Turn the water inlet hose anti-clockwise to unscrew it from the Washer Dryer and remove it by gently pulling.
- 2 Remove the water inlet filter from the water inlet valve by gently pulling on the plastic bar of the filter with a pair of long nosed pliers (see Figure 10).
- 3 Clean the filter using a soft brush and soapy water. Rinse thoroughly.
- 4 Gently re-insert the filter by pushing it back into place.

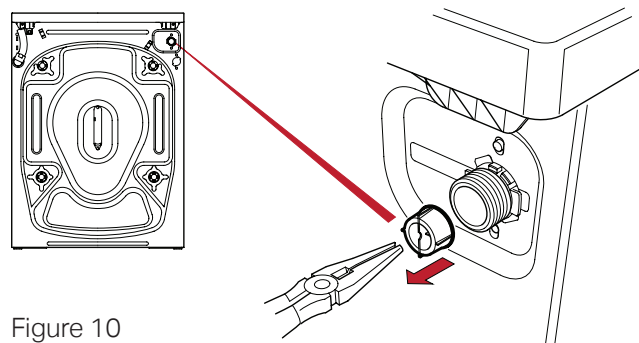

Figure 10

Another water inlet filter can be found in the tap end of the water inlet hose. To clean this filter:

- 1 Remove the filter by gently pulling on the plastic bar with a pair of long-nosed pliers.
- 2 Clean the filter using a soft brush and soapy water. Rinse thoroughly.
- 3 Gently re-insert the filter by pushing it back into place.

Taking Care of Your Washer Dryer

Pump Filter

It is important to keep the pump filter clean as it lengthens the lifetime of the pump by preventing lint from entering your Washer Dryer. We recommend that you carry out the following procedure every 2-3 months:



Note: The pump filter can be found behind the cover on the lower-front right corner of your Washer Dryer.



WARNING: Water in the pump may be hot. Allow it to cool before carrying out any maintenance.

- 1 Position a suitable sized container under the pump filter cover to collect any excess water left in the machine.
- 2 Pull the top of the pump filter cover forwards until the pump filter is fully exposed (see Figure 11(a)).
- 3 Turn the filter anti-clockwise until loose and remove by pulling (see Figure 11(b)).
- 4 Wait for the water to drain.
- 5 Clean the filter with a soft brush, making sure any unwanted materials are removed.
- 6 Move the pump by hand to check that it rotates freely.
- 7 Clean the pump with a soft brush.
- 8 Re-insert the filter and screw clockwise.
- 9 Close the pump filter cover.

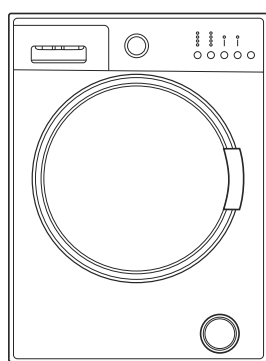
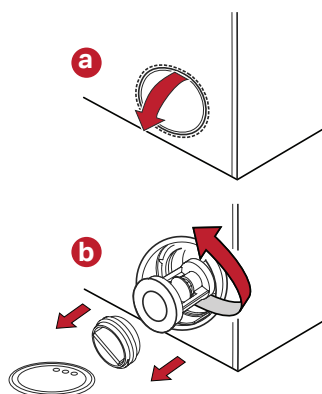

Figure 11



Detergent Drawer

Regular use of detergent may cause residual build up in the detergent drawer. We recommend that you clean the drawer at regular intervals to remove any residue.

To clean the detergent drawer:

- 1 Pull the drawer forwards until it is fully extended.
- 2 Press down on the release catch (see Figure 12) and gently pull the drawer away from the Washer Dryer.
- 3 Clean the drawer thoroughly with warm water and a soft brush.
- 4 Check the drawer housing for any residue and remove with a soft brush.



Note: Take care not to let any residue fall inside your Washer Dryer.

- 5 After cleaning, dry the drawer thoroughly and slide it back into place.

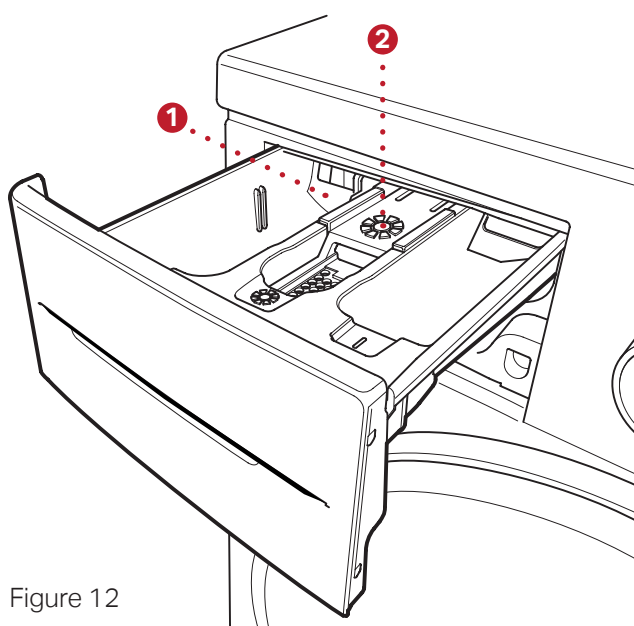



Figure 12

- 1 Release catch
- 2 Siphon plug

Taking Care of Your Washer Dryer

Siphon plug

The Siphon Plug can be found in the softener  compartment of the detergent drawer (see Figure 12). We recommend cleaning the plug at regular intervals.

To clean the Siphon Plug:

- 1 Pull the detergent drawer forwards until it is fully extended.
- 2 Remove the plug by pulling upwards.
- 3 Clean the plug with a soft brush.
- 4 Replace the plug, checking that it is securely in position.

Taking care of your laundry

We strongly recommend that you follow any guidance given on the labels of your laundry. Listed below is a handy reference of common international washing signs and their meanings.



Washing Temperature



Dry Clean Only

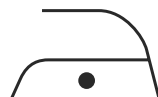

Lukewarm Iron



Medium Hot Iron

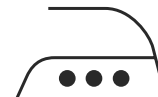

Hot Iron



Do Not Iron

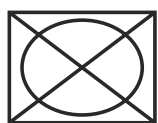

Do Not Tumble Dry

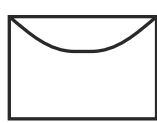

Hang To Dry

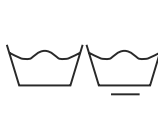

Normal Washing



Drip Dry

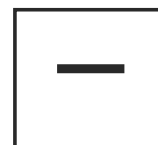

Dry Flat

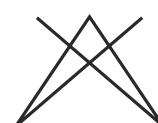

Do Not Bleach



Can Be Bleached In Cold Water



Can Be Bleached

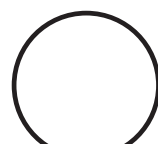

Can Be Dry Cleaned

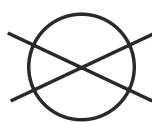

No Dry Cleaning



These letters are used to instruct professional cleaners as to which type of solvent to use. Do not wash garments with these symbols in your Washer Dryer unless the label says otherwise.

Problem Solving

In the unlikely event that your Washer Dryer is not operating as expected, you may find a solution listed in the table below.

Fault detection system

Your Washer Dryer has a built-in fault detection system. If a fault is detected, a code is displayed on the control panel. The table below lists the most common fault codes along with possible solutions.

Fault	Possible Cause	Solution
Your Washer Dryer does not operate	It is switched off at the mains	Make sure your Washer Dryer is plugged in and turned on at the mains
	The programme dial is in the STOP position	Use the programme dial to select the desired programme
	The door is not shut properly	Close the door until you hear it click shut
Your Washer Dryer does not receive water	The cold water supply tap is off	Check the cold water supply tap is fully turned on
	The water fill hose is bent twisted, kinked or trapped	Check there are no bends, twists or kinks and that the fill hose is not trapped
	The water inlet filters are blocked	Clean the water inlet filters. See page 20.
	The door is not shut properly	Close the door until you hear it click shut
Your Washer Dryer is not draining water	The drain hose is bent, twisted, kinked or trapped	Check there are no bends, twists or kinks and that the drain hose is not trapped
	The pump filter is obstructed	Clean the pump filter. See page 21
Your Washer Dryer is vibrating	The feet of your Washer Dryer have not been correctly adjusted	Adjust the feet. See page 9
	The transportation safety screws have not been removed	Remove the transportation safety screws. See page 8
	There is only a small amount of laundry in your Washer Dryer	This will not affect the operation of your Washer Dryer
	There is too much laundry in your Washer Dryer	Check that the maximum capacity of your Washer Dryer is not exceeded. See pages 14-16.
	Your Washer Dryer is on a hard surface	Do not install your Washer Dryer on a hard surface or less than 2 cm from walls.
There is excessive foam in the detergent drawer	Too much detergent has been used	Press the Start/Pause button. To reduce the amount of foam, dilute one tablespoon of softener into ½ of water and pour into the detergent drawer. Press the Start/Pause button after 5-10 minutes. Reduce the amount of detergent used in your next wash.
	The wrong detergent has been used.	Only use detergents produced for automatic Washer Dryers

Problem Solving

Fault	Possible Cause	Solution
The washing result is not as expected	The laundry is too dirty for the programme you have selected	Use the information on pages 14-16 to select the most appropriate programme.
	Not enough detergent has been used	Use the amount of detergent as instructed on the packaging
	There is too much laundry in your Washer Dryer	Check that the maximum capacity of your Washer Dryer has not been. See pages 14-16.
The water from the machine is drained as soon as it is filled	The end of the water drain hose may be too low	Check the drain hose is set at a suitable height. See page 10.
No water can be seen in the drum during washing		There is no fault. Water is in a non-visible part of the drum
There is detergent residue on your laundry after washing	Non-dissolving particles of some detergents may appear on your laundry as white spots	Perform an extra rinse by using the Rinse programme or clean your laundry with a brush after it dries
	There is untreated oil, cream or ointment on your laundry	Use the amount of detergent as instructed on the packaging in the next wash
The spin cycle does not take place	The in-built sensor has prevented your Washer Dryer from operating with an out-of-balance load	The load control system will try to spread your laundry evenly before the spinning cycle takes place. Aim to evenly spread your laundry in the next wash

Fault detection system

Your Washer Dryer has a built-in fault detection system. If a fault is detected, a code is displayed on the control panel. The table below lists the most common fault codes along with possible solutions.

Error Code	Possible Fault	Solution
E01	The door is not shut properly	Shut the door properly so that you hear the click
E02	The water in your Washer Dryer may be low. The water pressure may be low.	Check that the cold water tap is fully turned on.
E03	The pump is faulty or the pump filter is blocked	Clean the pump filter. See page 21.
E04	There is an excessive amount of water in your Washer Dryer	Your Washer Dryer will automatically drain the water. Turn your Washer Dryer off, unplug it from the mains supply and contact the Montpellier customer service helpline on 03333 234 473.

If the information in the tables above does not list the fault you are experiencing, call the Montpellier customer service helpline on: **03333 234 473**.

Technical Specifications

Model	MWD7512P
Colour	White/Black
Voltage V/Frequency (Hz)	220-240 V, 50 Hz
Electrical Current (A)	13
Water Consumption (l/Cycle) (Washing, Spinning and Drying)	118
Energy Consumption (kWh/Cycle) (Washing, Spinning and Drying)	5.67
Energy Consumption (kWh/Cycle) (Washing, Spinning only)	1.23
Energy Rating	B
Washing Performance Class	A
Spin Speed (rpm)	1200
Max Load Capacity (Washing) (kg)	7
Max Load Capacity (Drying) (kg)	5
Height (cm)	85
Width (cm)	60
Depth (cm)	60
Features	Delay Start Unbalanced Control System Adjustable Temperature and Spin Settings Child Lock

Product Fiche

1	Supplier's Trade Mark	Montpellier
2	Supplier's Model Identifier	MWD7512P
3	Energy Efficiency Class	B
5	Energy Consumption (Washing, Spinning, Drying) (kWh/Cycle)	5.67
6	Energy Consumption (Washing and Spinning Only) (kWh/Cycle)	1.23
7	Washing Performance Class	A
8	Water Remaining after Spin (%) (as a proportion of dry weight wash)	53
9	Max Spin Speed (rpm)	1200
10	Washing Capacity (Cotton 60° full load) (kg)	7
11	Drying Capacity (kg)	5
12	Water Consumption (Washing, Spinning, Drying) (l/Cycle)	118
13	Water Consumption (Washing and Spinning only) (l/Cycle)	53
14	Washing and Drying Time (minutes)	517
16	Energy Consumption (Washing, Spinning, Drying) (kWh/annum)*	1134
	Water Consumption (Washing, Spinning, drying) (l/annum)*	23600
17	Energy Consumption (Washing and Spinning only) (kWh/annum)**	246
	Water Consumption (Washing and Spinning only) (l/annum)**	10600

- The actual water temperature may differ from the declared cycle temperature
- Programme duration, energy consumption and water consumption values may vary according to:
 - Wash load weight and type
 - Selected extra functions
 - Tap water
 - Ambient temperature

*Estimated annual consumption for a four person household always using dryer (200 cycles)

**Estimated annual consumption for a four person household never using dryer (200 cycles)

Here For You

After-sales assistance

If you continue to experience problems with your Washer Dryer, please call the Montpellier customer service helpline on: **03333 234 473**.

Please have all your product details available, including the model number, serial number, date of purchase, and your retailer's details before registering a fault.

The service call cannot progress without this information.

Your 2 year Manufacturer's guarantee

THIS DOES NOT AFFECT YOUR STATUTORY RIGHTS.

Your new Montpellier appliance carries a free guarantee which protects you against the cost of repairs during the first 24 months from date of purchase provided that:

Any claim is accompanied by evidence of the model reference, model serial number and proof of purchase, such as a Sales Receipt, showing that the appliance was purchased within the 24 months prior to the date of claim.

What is not covered under the Guarantee

- Any appliance not correctly installed and operated in accordance with the manufacturer's instructions.
- Any appliance that is used for anything other than domestic purposes.
- Any defect caused by accident, misuse, unauthorised modification or inexperienced repair.
- Cost of Call-out where a fault cannot be found with the appliance.
- Cost of Call-out for work covering routine maintenance, such as, but not exclusively, cleaning of filters or defrosting.
- Cost of Call-out for work required to correct the alignment of doors following door reversal procedures carried out by you.
- Use of the appliance by anyone other than the Householder.
- Use in any commercial environment.
- Consumable items, such as, but not exclusively, fuses in plugs, bulbs and breakable items which require routine replacement.
- Repair costs incurred that have not been authorised by Repairtech and/or carried out by a non-approved Repairtech engineer.

YOUR GUARANTEE IS VALID ONLY IN THE UK.

To register your appliance simply complete the card in your appliance pack and return it with a stamp affixed or alternatively you can register online at **www.montpellier-appliances.com/support**

SERVICE HELP-LINE

Should your appliance develop a fault, please call the Montpellier customer service helpline on: **03333 234 473**.

Please remember to have all your product details available, including the model number, serial number, date of purchase and your retailer's details before registering a fault.

Your service call cannot progress without this information.

Montpellier Domestic Appliances Ltd.

Unit 1, Tewkesbury Retail Park, Northway Lane,
Tewkesbury, Gloucestershire GL20 8JU

www.montpellier-appliances.com



The symbol on the product or on its packaging indicates that this product may not be treated as household waste. Instead it shall be handed over to the applicable collection point for the recycling of electrical and electronic equipment. By ensuring this product is disposed of correctly, you will help prevent potential negative consequences for the environment and human health, which could otherwise be caused by inappropriate waste handling of this product. For more detailed information about recycling of this product, please contact your local city office, your household waste disposal service or the shop where you purchased the product.